

APPENDIX 6
OTHER AIRPORT PROJECTS

- 6-A Adjacent Projects
- 6-B Temporary Concessions Plan

APPENDIX 6-A
ADJACENT PROJECTS

- CBRA Project

APPENDIX 6-B

TEMPORARY CONCESSIONS PLAN

To continue concession services to the passengers, meeters/greeters and employees at DEN, the Owner will deploy temporary concession units within Developer's proposed concessions development spaces during the Project Construction Period in accordance with the following.

The identification of space available to locate temporary concessions and the number of temporary concession units is highly dependent on the Initial Transition and Phasing Plan. As such, the Owner reserves the right, after consultation and approval with Developer, to modify this plan to reflect any revisions to the Initial Transition and Phasing Plan.

Therefore, the Owner contemplates the following initial temporary concessions development:

1. In general, inside of the main Terminal building, the Owner intends to provide two or more quick service food and beverage kiosk or temporary built units. These units will require some utility provisions and possibly access to a potable water source and waste water drainage area. The possible concepts activated on these units may include the provision for alcohol sales.
2. The locations identified for temporary concession unit development is in and around the areas identified for the significant architectural feature, A5-34 and A5-35 spaces. See the area identified in yellow in the Phasing Drawings below. The development of these units are planned to occur sometime late in Phase 1 and will operate through Phases 2 and 3. They are intended to close sometime during Phase 4 and preferably not before the commencement of concession operations in the Landside Plaza. Commercial offer terms are expected to cover the total activation period.
3. Additionally, two temporary concessions developments will occur outside of the south terminal window wall on the Level 5 Hotel Plaza. See the areas identified in blue in the Phasing Drawings below. Both of these locations are intended for the development of "food trucks" to meet the projected customer and employee demand. The food trucks will be activated at the beginning of Phase 1 and will continue to operate through Phases 2 and 3. They are intended to close sometime during Phase 4 but not before the commencement of concession operations in the Landside Plaza. The quick service food & beverage concepts offered by the food trucks will rotate on a to-be-determined basis, once the

commercial plan has been finalized. Commercial offer terms are expected to cover the total activation period.

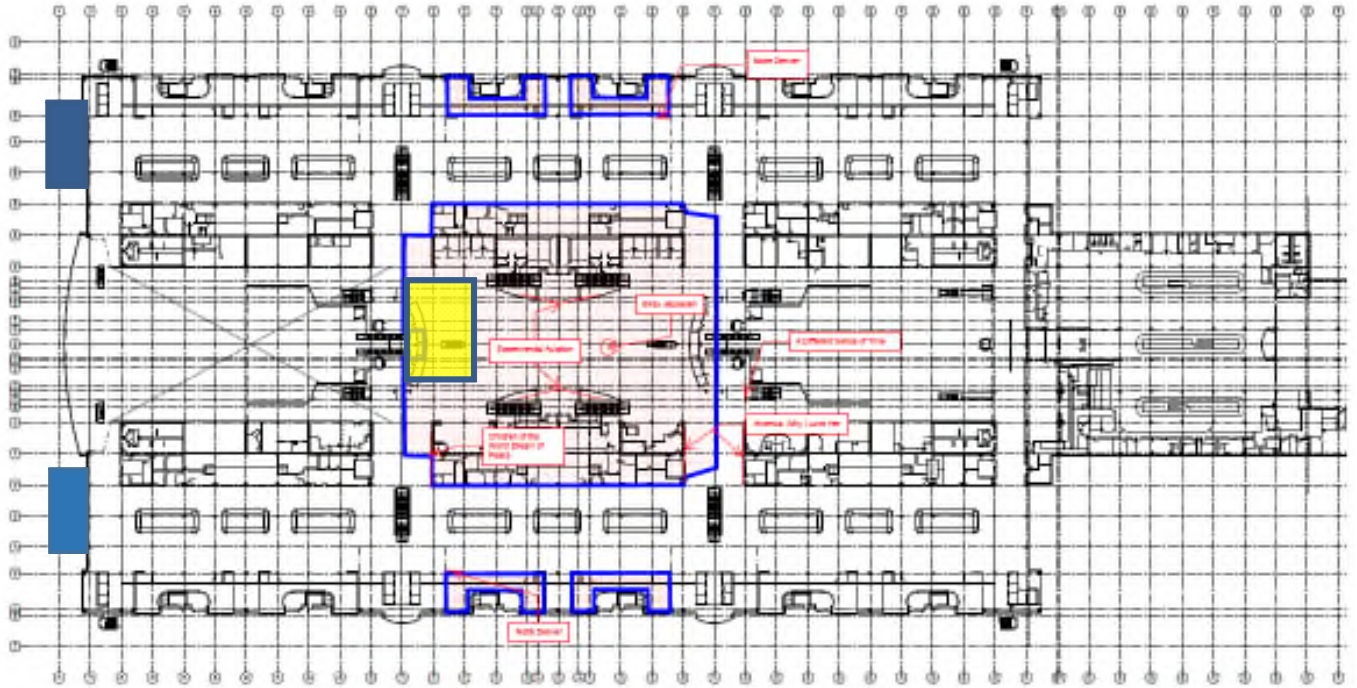

Phase 1 Lvl 5 Work Area

Phase 1 Duration: 11 months
Version 1: May 1, 2017

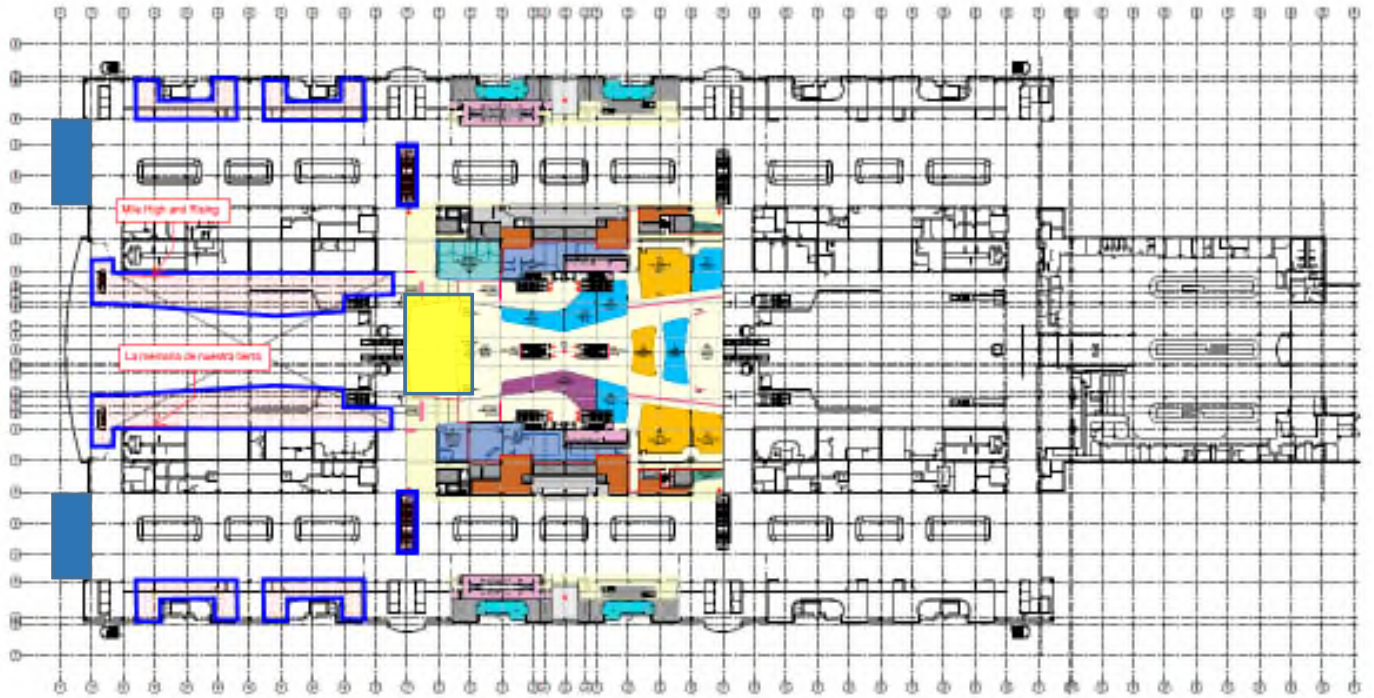

Phase 2 Lvl 5 Work Area

Phase 2 Duration: 18 months
Version 1: May 1, 2017

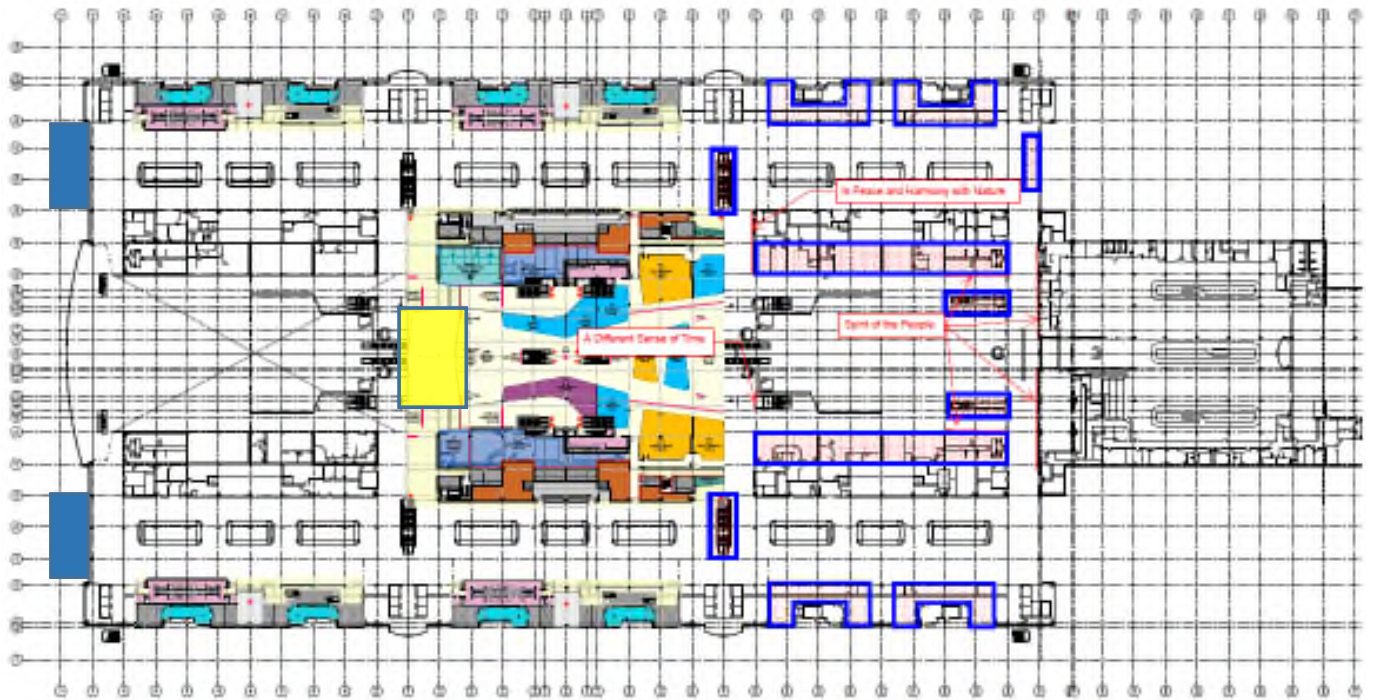

Phase 3 Lvl 5 Work Area

Phase 3 Duration: 18 months
Version 1: May 1, 2017