



DENVER PUBLIC LIBRARY

ACTIVATE! DENVER



4+ million
visitors



13+ million
online
visitors

400,000+ people
attend programs

**44,000+ kids
in Summer
Reading**



**670,000
hours
public
computer
use**



3,000,000+
wireless
sessions



**70% of Denver
residents have a
library card**



~9 million
items
checked out

Mission

**The Denver Public Library
connects people with information,
ideas and experiences to provide
enjoyment, enrich lives and
strengthen our community.**

Community Impacts



- * Children enjoy reading and learning and flourish in school and life.
- * People connect to resources and acquire the skills they need to thrive.
- * We build community through fun, inspiring and creative experiences.



**Children enjoy
reading and
learning and
flourish in school
and life.**

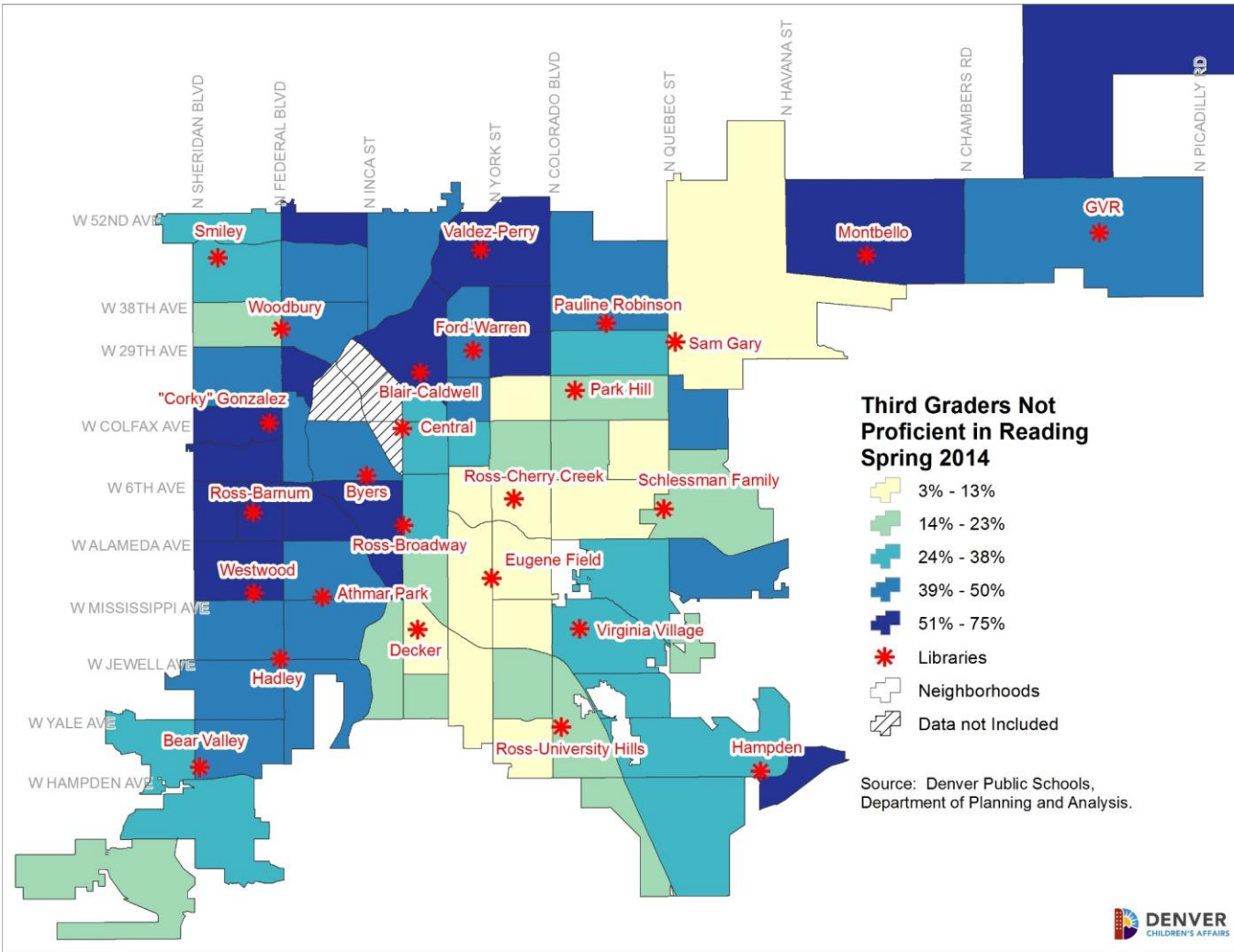



SUMMER OF READING

June 1–Aug. 13



DENVER
PUBLIC
LIBRARY





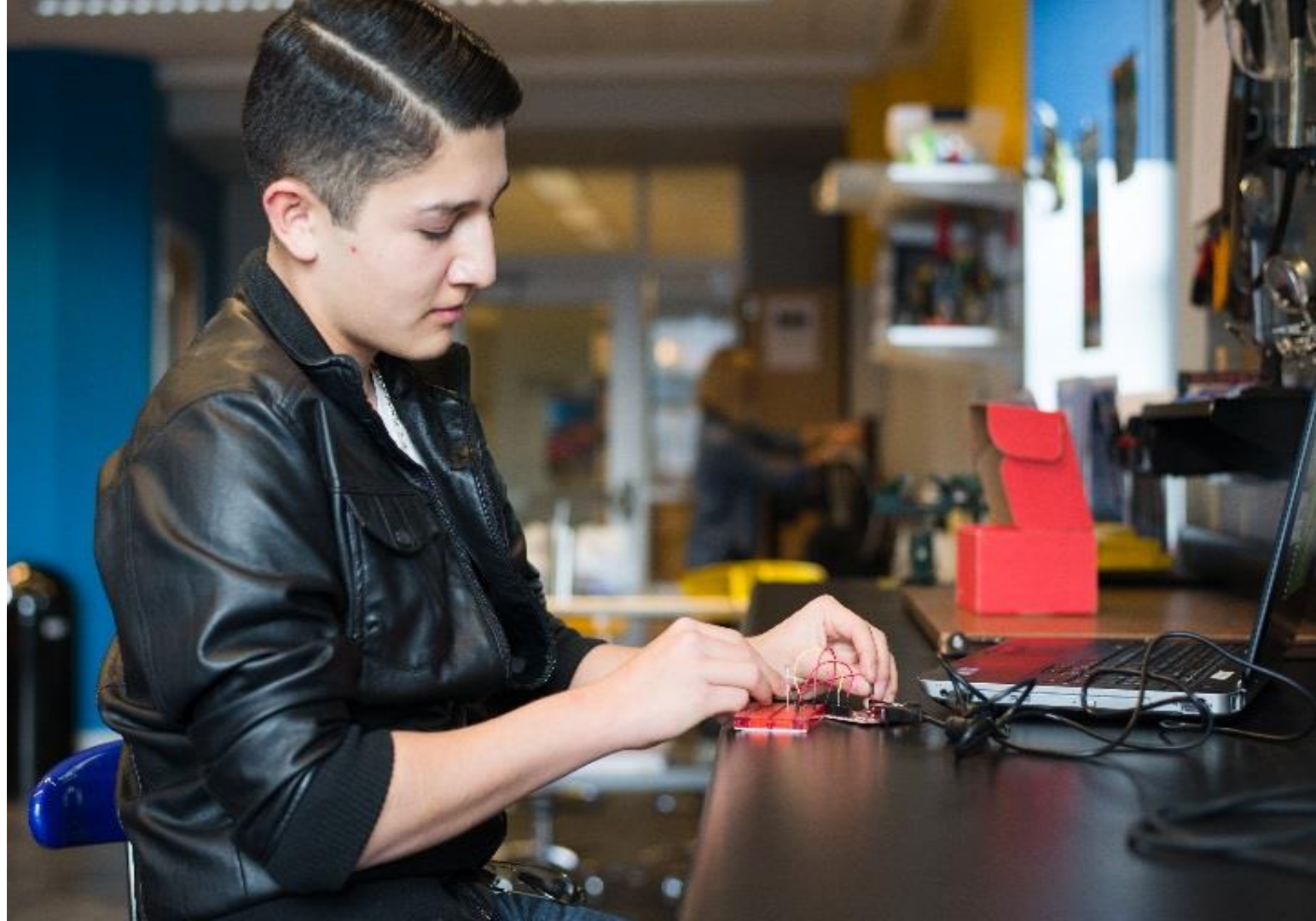



People connect to resources and acquire the skills they need to thrive.

SE COMPUTER

Library databases only
for assistance logging on.

Source of information
and research

Computers are used for
selected library
services. If you are not
with a librarian in a
of appointment we
ask you to move to
database computer.
Thank you

DATABASE COMPUTER

This computer accesses Library databases only.
Please ask a librarian for assistance logging on.

University Library

Home Page

Log In

Database

SERVICES

Identify and
access
resources

for
with
or a
in
on.

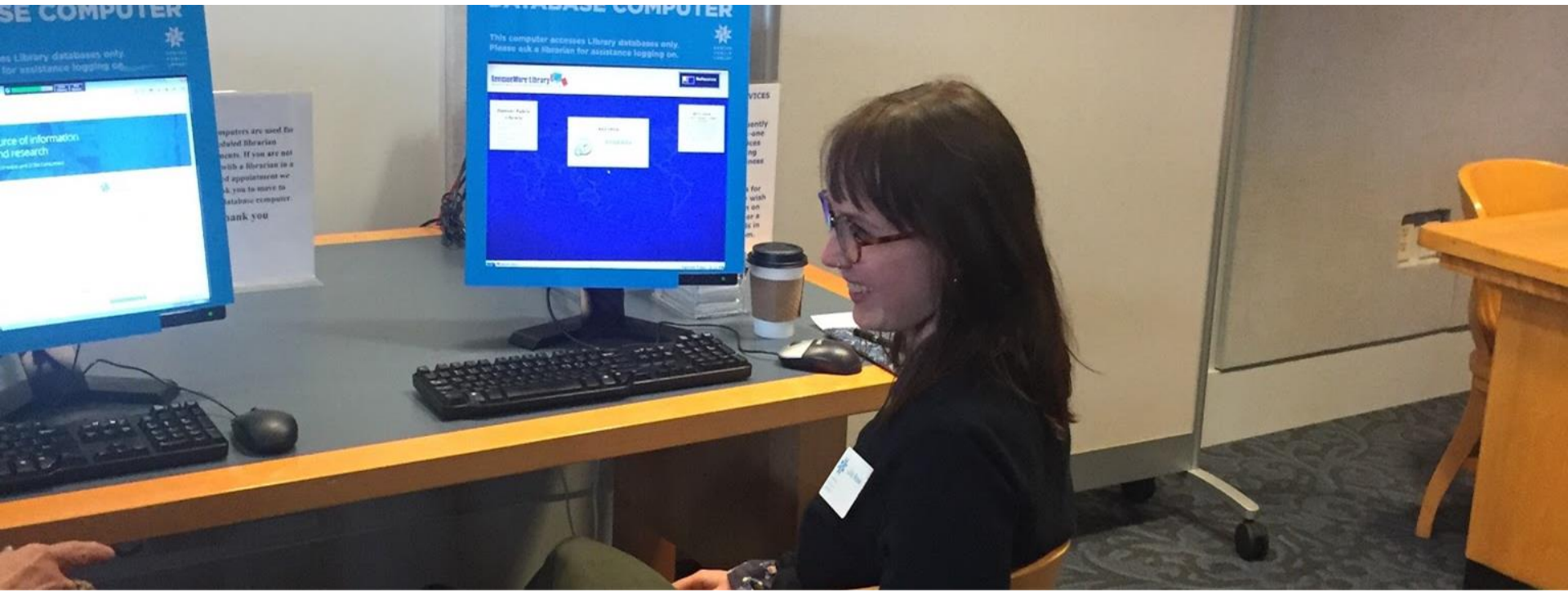

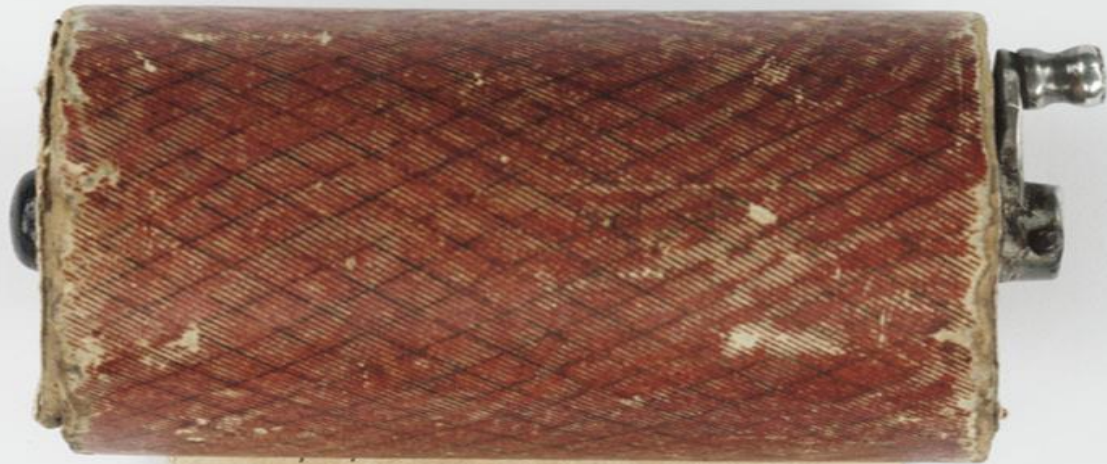

Ribbon Map
OF THE
FATHER OF WATERS

*Steamboat fares vary from two to four
cents per mile, Staterooms and meals included*

Gast, Moeller & Co. 15th Cor. Third and Olive Sts. St. Louis



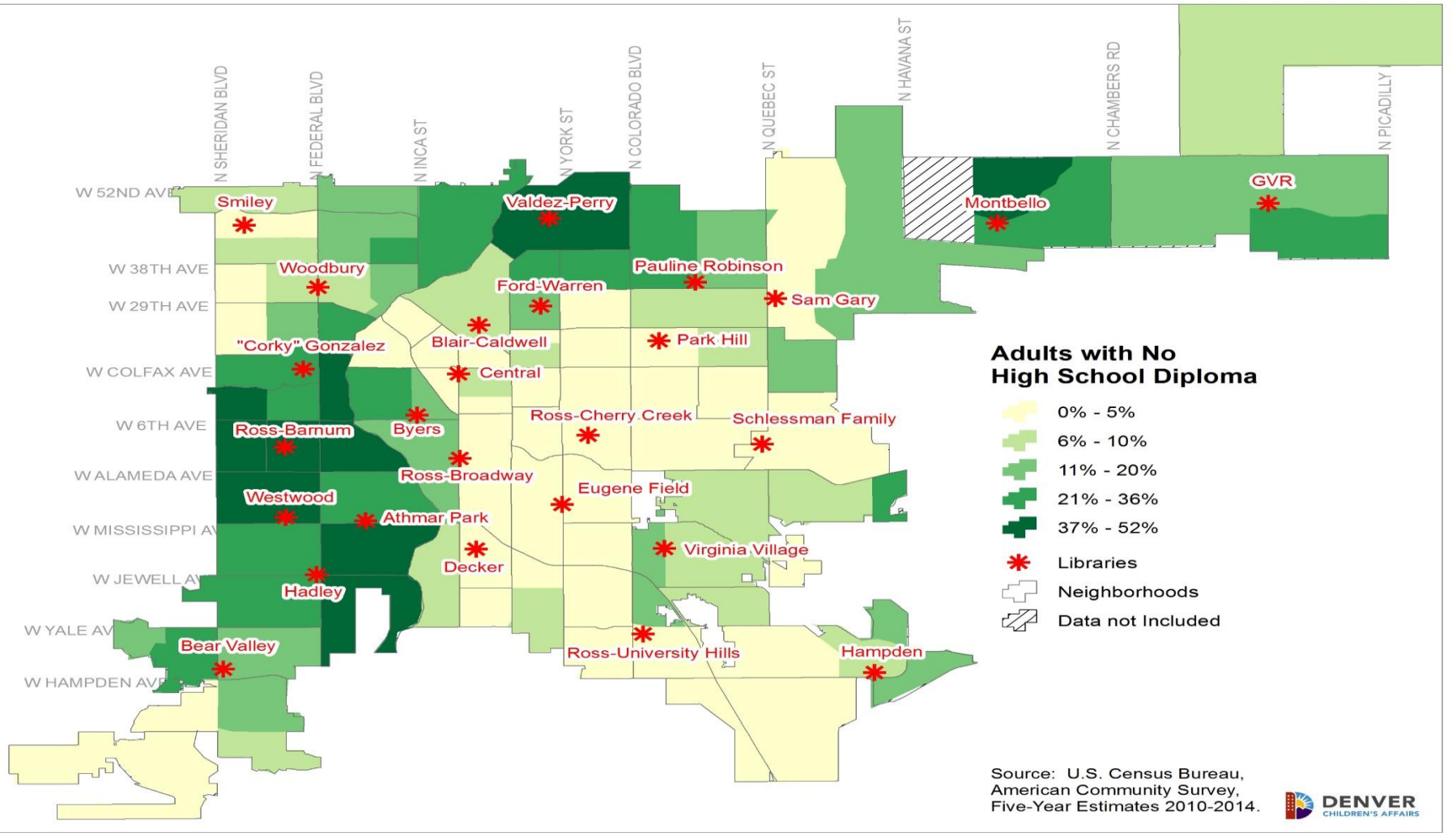



Among all American adults, the % who use the internet, by income

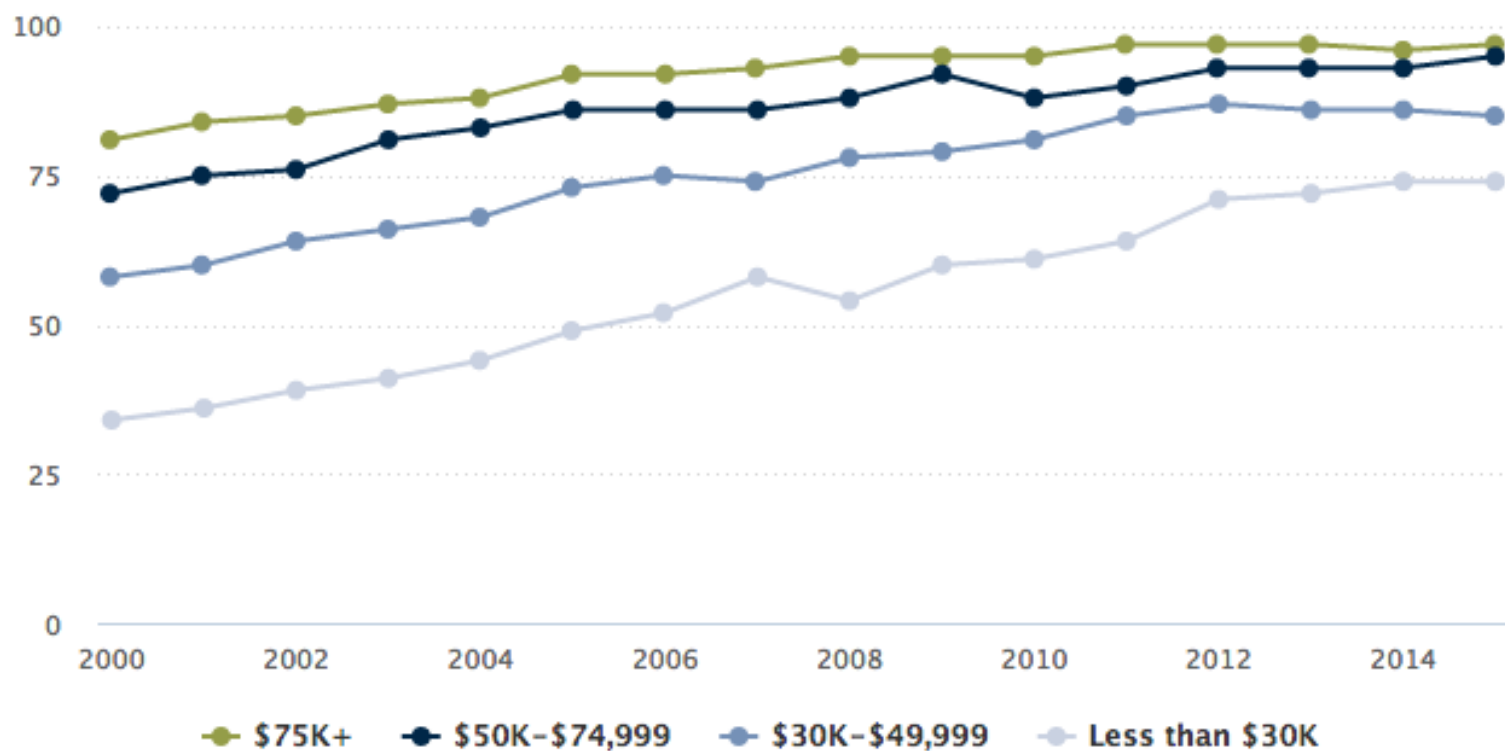



Foreign-Born Population Percentage by Neighborhood

Denver Office of Community Support

City and County of Denver

City-wide Assets by Neighborhood with Foreign-Born Population

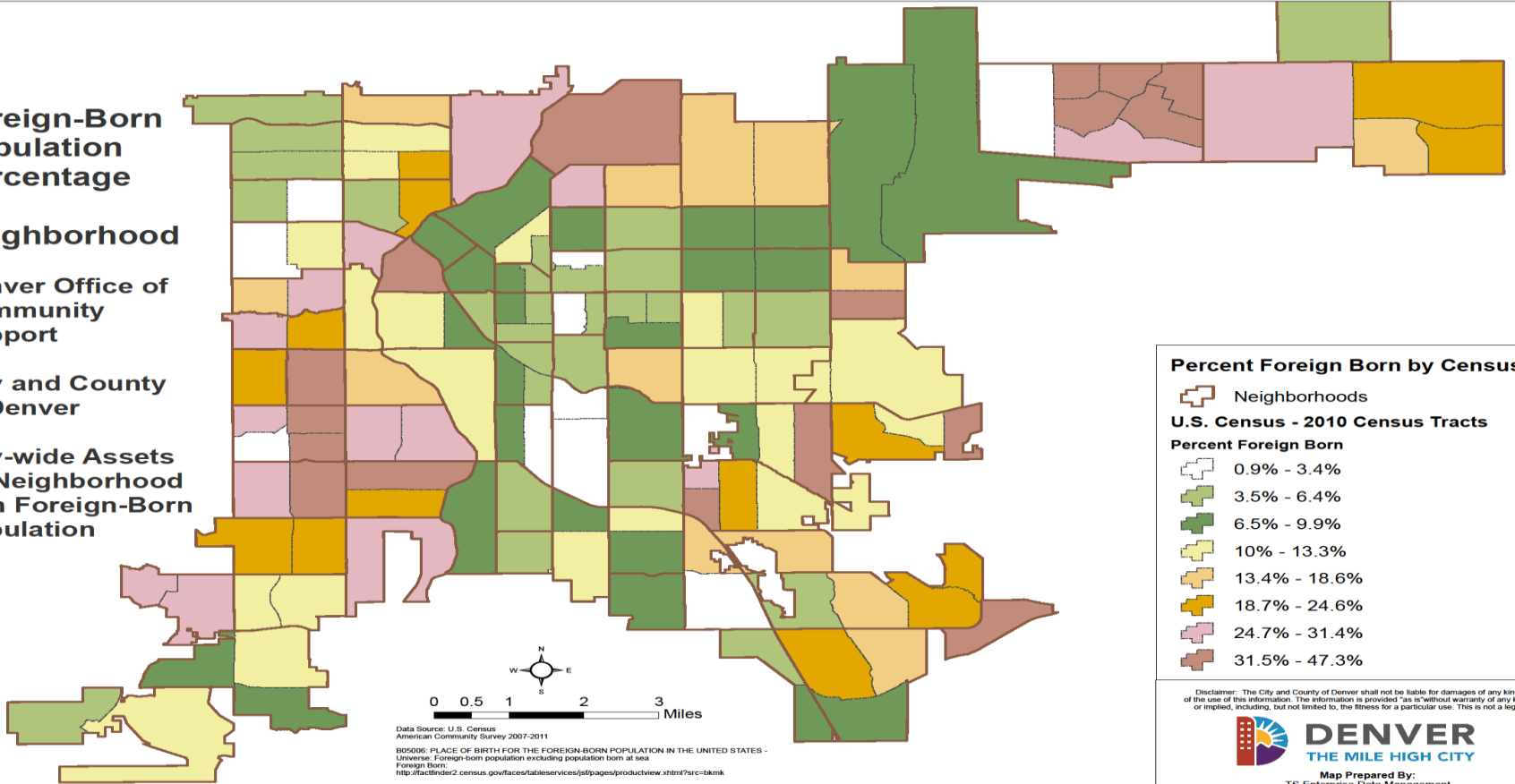









Percent Foreign Born by Census Tract

 Neighborhoods

U.S. Census - 2010 Census Tracts

Percent Foreign Born

-  0.9% - 3.4%
-  3.5% - 6.4%
-  6.5% - 9.9%
-  10% - 13.3%
-  13.4% - 18.6%
-  18.7% - 24.6%
-  24.7% - 31.4%
-  31.5% - 47.3%

Disclaimer: The City and County of Denver shall not be liable for damages of any kind arising out of the use of this information. The information is provided "as is" without warranty of any kind, expressed or implied, including, but not limited to, the fitness for a particular use. This is not a legal document.



DENVER
THE MILE HIGH CITY

Map Prepared By:
TS Enterprise Data Management
Date: 11/25/2013

Data Source: U.S. Census
American Community Survey 2007-2011

B05006: PLACE OF BIRTH FOR THE FOREIGN-BORN POPULATION IN THE UNITED STATES -
Universe: Foreign-born population excluding population born at sea
Foreign Born
<http://factfinder2.census.gov/faces/tableservices/jsf/pages/productview.xhtml?src=bkmk>

Total Population:
http://factfinder2.census.gov/faces/tableservices/jsf/pages/productview.xhtml?pid=ACS_11_5VR_B01003&prodType=table







**We build
community
through fun,
inspiring and
creative
experiences.**







#NewSchoolLibrarian



#OldSchoolLibrarian



DENVER PUBLIC LIBRARY

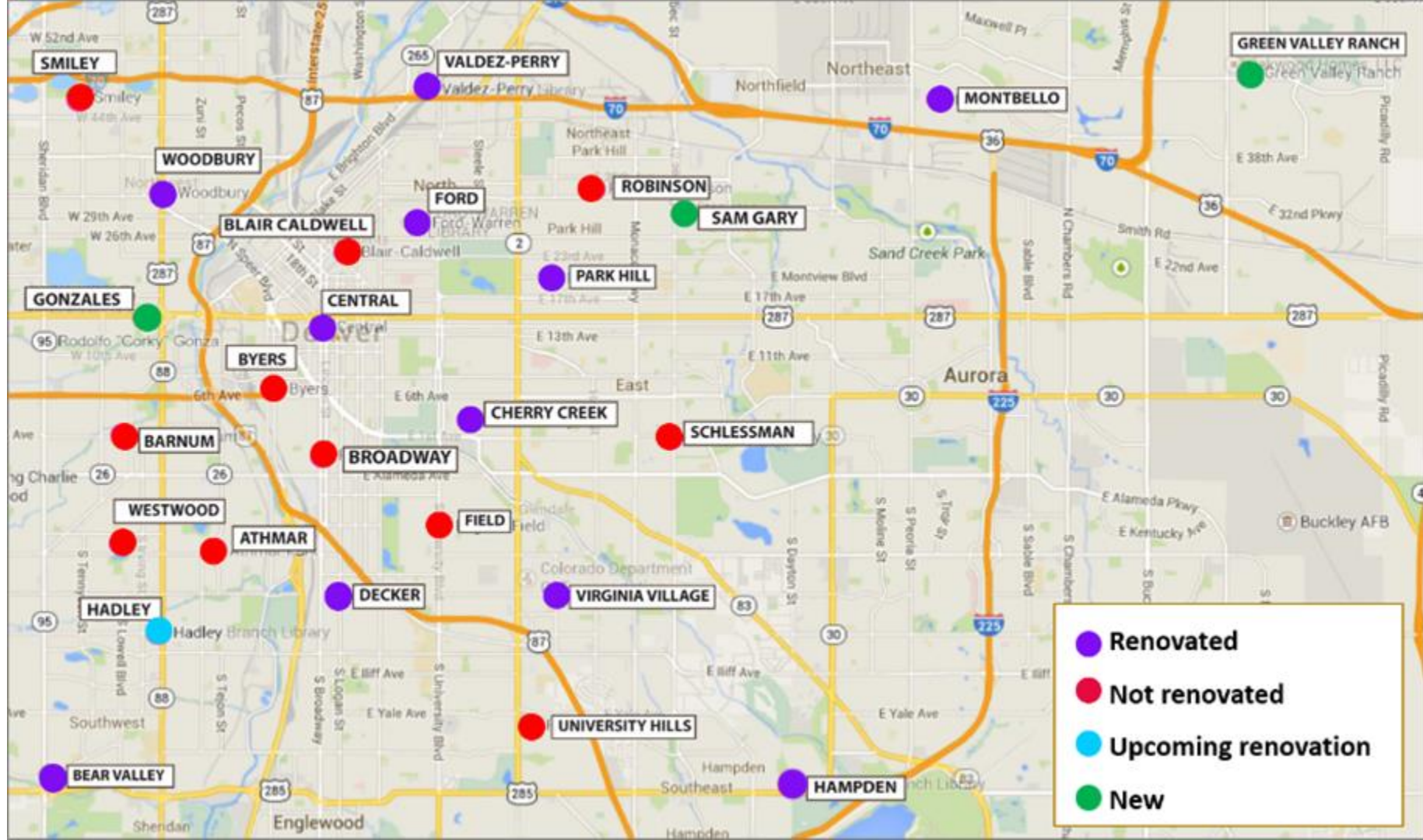















(RE)IMAGINING

DENVER CENTRAL LIBRARY



June 9, 2016: Steering Committee Meeting
 June 15, 2016: Existing Building Walk-Through
 June 16, 2016: Steering Committee Meeting
 June 20, 2016: Acoma Plaza | Denver Central Library and Denver Art Museum North Building Renovation Workshop
 June 21, 2016: Existing Building Walk-Through
 June 21, 2016: Friend Book Sale: "Tell an Architect Survey"
 June 23, 2016: Steering Committee Meeting
 June 30, 2016: Steering Committee Meeting
 July 6, 2016
 8-9:30 a.m., Staff, Conference Center
 9:30am - 10am Meet with architects (Jacob Sheets)
 10am - 10:30am Meet with architects (Robert Rains)
 10:30 - 11 a.m. Table Top: Toddler Storytime
 10:30-11:30 a.m., Educators, Gates
 11:30 a.m.12:30 p.m., Table Top: Baby Play
 12:30-1:30 p.m., Business Community
 2 - 3:30 p.m. Table Top: "Rad Science" Children's Program
 2:30-3:30 p.m., Culturals
 3 - 6 p.m. Table Top: IdeaLAB open for teens
 4-5:30- p.m. Community Meeting
 July 7, 2016: Steering Committee Meeting
 July 11, 2016
 8:30-10 a.m. Staff Meeting
 10:30 - 11 a.m. Baby Storytime
 10:30 - 11:30, Monday Morning Meditation (homeless population)
 11:45 - 12:30, People experiencing homelessness/poverty
 1-2 p.m. People with Disabilities
 2pm - 2:30pm Meet with architects (Genine Plunkett)
 2:30pm - 3pm Meet with architects (Elaine Langeberg)
 3pm - 3:30pm Meet with architects (Mary Kuehner)
 3:30pm - 4pm Meet with architects (Jennifer Hoffman)
 4-5 p.m. Eteam/Commission
 5:30 - 7 p.m., Table Top: Discovery Night Children's Program
 6-7:30 p.m., Community

July 14, 2016: Steering Committee Meeting
 July 15, 2016:
 9:30-10:00 Meet with architects (Tracy Treece)
 10:00-10:30 Meet with architects (Anne Kemmerling)
 10:30-11:00 Meet with the architects (Matt Hamilton)
 11:00-11:30 Meet with the architects (Sherry Spitsnaugle)
 11:30-12:00 Meet with the architects (Elissa Hardy)
 12:00-12:30 Meet with the architects (Chandra Jones)
 12:30-1:00 Meet with the architects (Corinne Jackamore)
 1:00-1:30 Meet with the architects (Chris Henning)
 1:30-2:00 Meet with the architects (Mary Mouton)
 2:0 0-2:30 Meet with the architects (Stacey Watson)
 2:30-3:00 Meet with the architects (Seana O'Grady)
 3:00- 3:30 Meet with the architects (Jim Kroll)
 3:30-4:00 Meet with the architects (Ann Schwab)
 4:00-4:30 Meet with the architects (Genine Plunkett)

Gather:

We Heard:

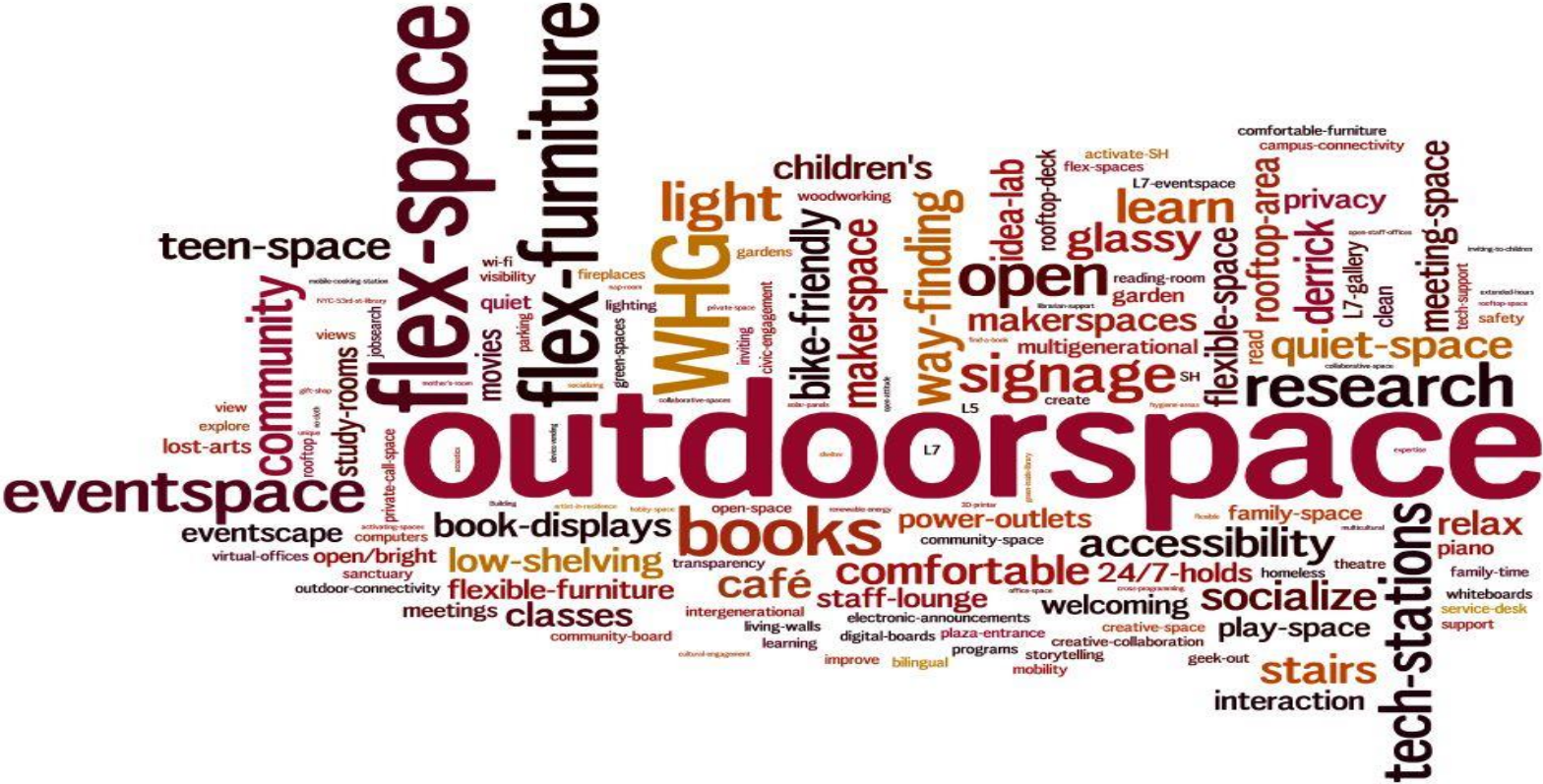

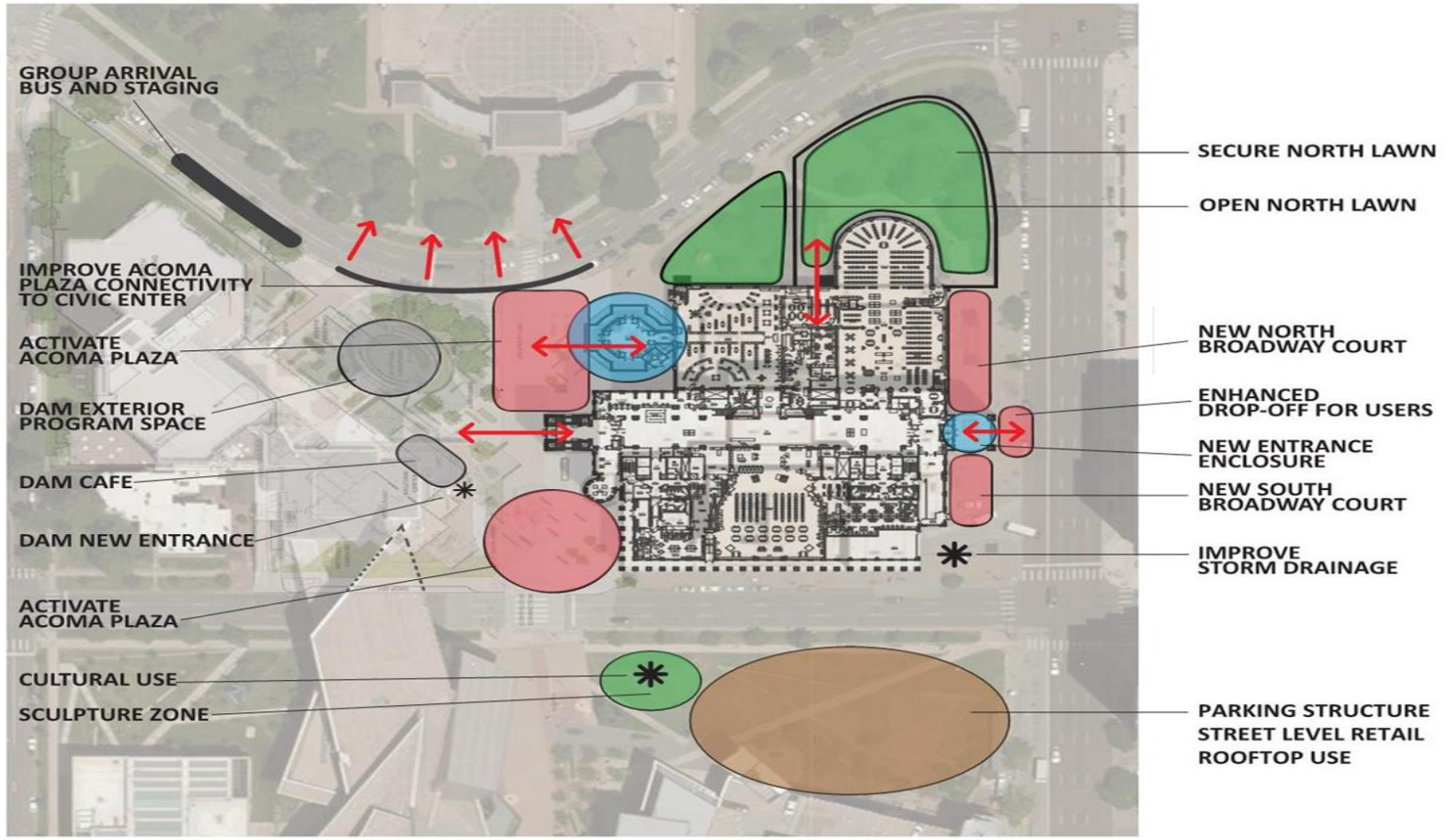

GROUP ARRIVAL
BUS AND STAGING

IMPROVE ACOMA
PLAZA CONNECTIVITY
TO CIVIC ENTER

ACTIVATE
ACOMA PLAZA

DAM EXTERIOR
PROGRAM SPACE

DAM CAFE

DAM NEW ENTRANCE

ACTIVATE
ACOMA PLAZA

CULTURAL USE

SCULPTURE ZONE

SECURE NORTH LAWN

OPEN NORTH LAWN

NEW NORTH
BROADWAY COURT

ENHANCED
DROP-OFF FOR USERS

NEW ENTRANCE
ENCLOSURE

NEW SOUTH
BROADWAY COURT

IMPROVE
STORM DRAINAGE

PARKING STRUCTURE
STREET LEVEL RETAIL
ROOFTOP USE

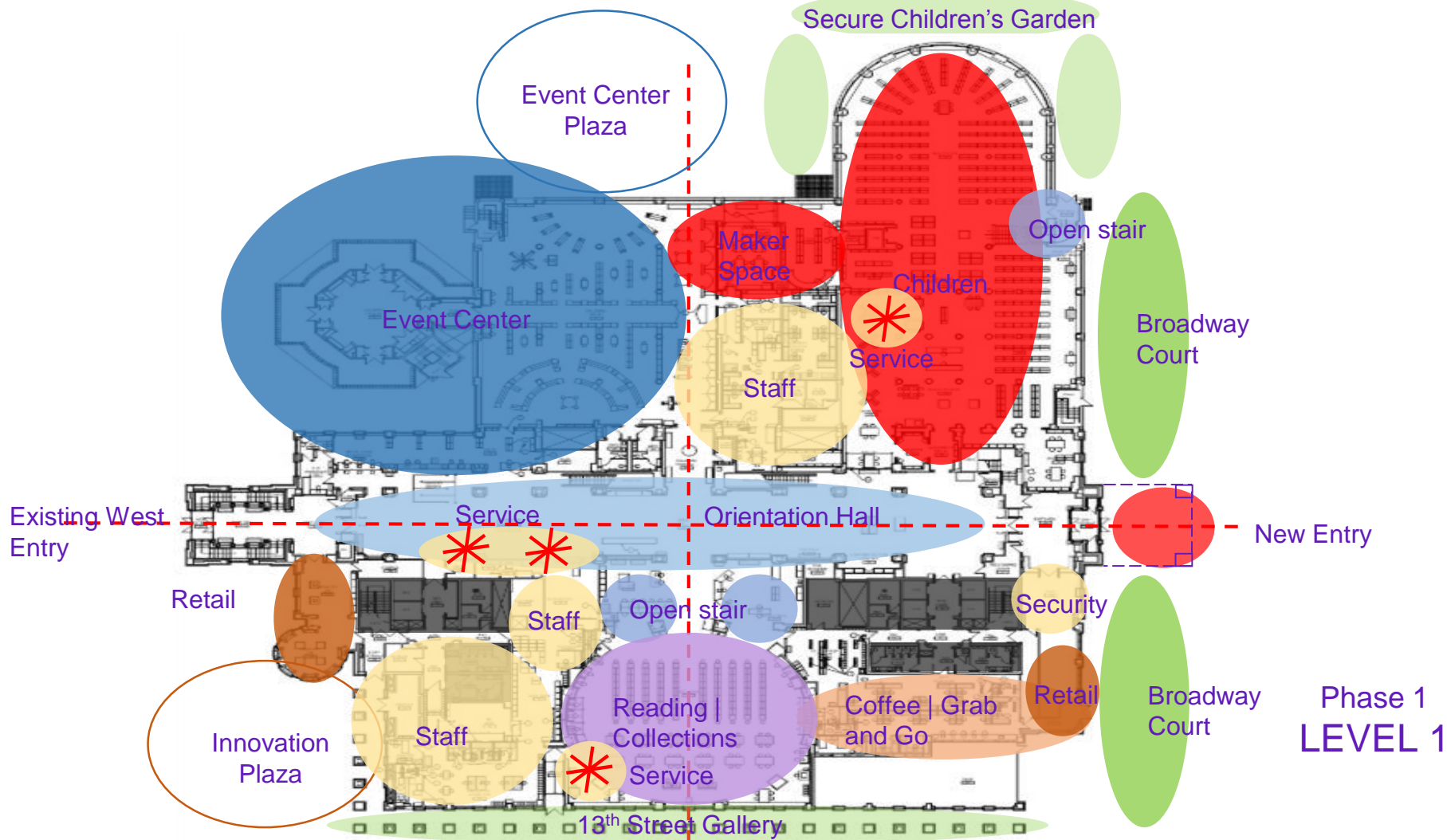

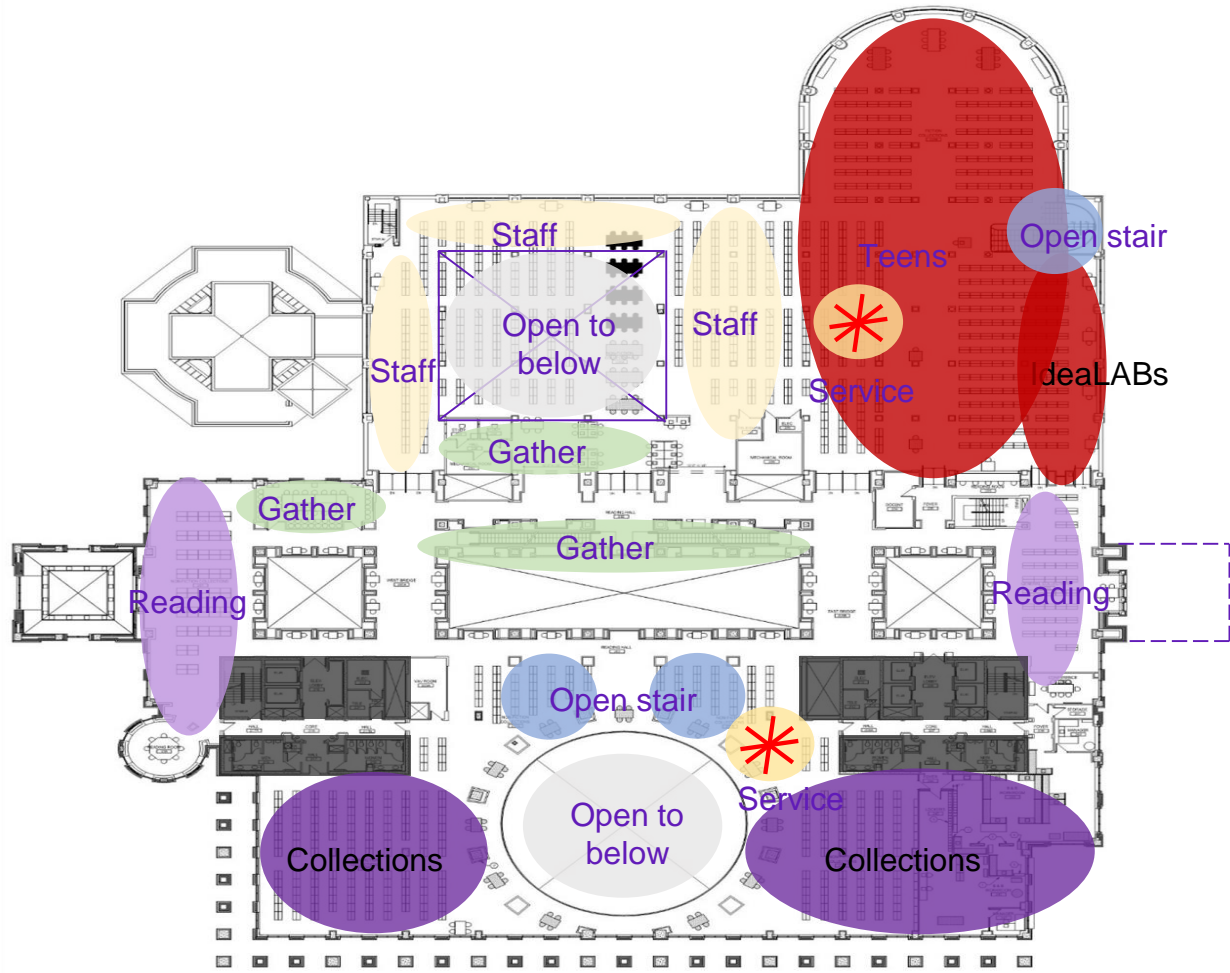

Phase 1
LEVEL 2

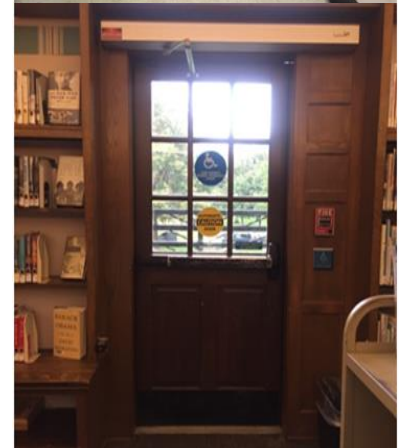

Some of the problems...

Smiley Branch Library

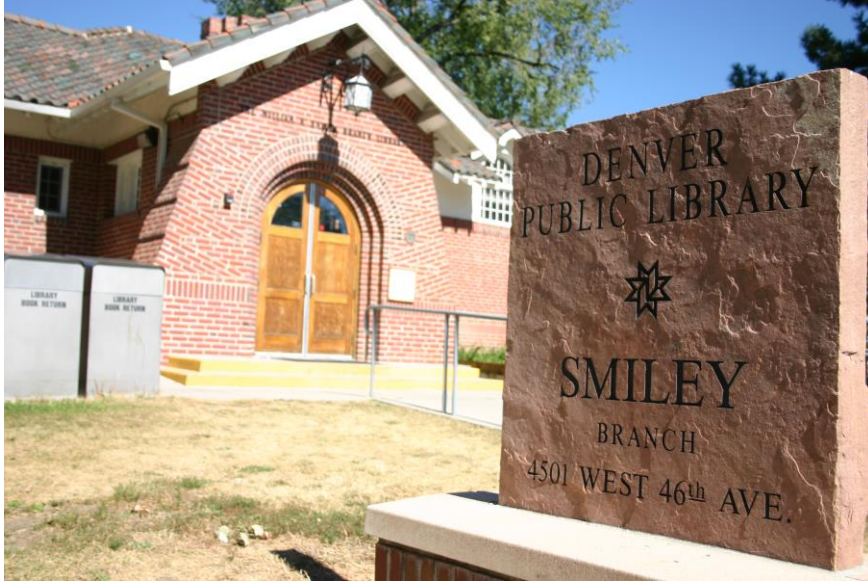

- Configure spaces to better accommodate families and children
- Major renovations are needed to restore, maintain and protect this treasured 100-year old Carnegie library
- Adaptations needed to make the facility ADA compliant and accessible to all residents
- Create community spaces to meet the neighborhood's changing demographics

Byers Branch Library



- Create much-needed community spaces for meeting, learning and making
- Neighborhood needs experiential space to keep youth engaged and learning
- Repair, restore, maintain and protect this treasured 100-year Carnegie library
- Adaptations needed to make the facility ADA compliant and accessible to all residents

Ross-Broadway Branch Library



- Create new and expanded spaces that meet the changing demographics of the neighborhood—from meeting rooms to learning and technology areas
- Restore and renovate inside and outside building components to protect this historic South Broadway gem
- As nearby neighborhoods continue to diversify, renovations are needed to serve separate and distinct customers from young urban professionals to long term retirees

Athmar Park Branch Library



- Neighborhood needs experiential space to keep youth engaged and learning
- Create new and expanded spaces that meet the changing demographics of the neighborhood
- Increase square footage to provide space for community to gather and connect
- Expand children's area to provide opportunities for out-of-school learning and help bolster early literacy levels

Ross-University Hills Branch Library



- Redesign the children's area to create a literacy-rich play space where parents and young children come together to learn and read
- Adaptations needed to make the facility ADA compliant and accessible to all residents
- Bring building components up to current standards to increase energy efficiency, improve climate control and provide better security

Pauline Robinson Branch Library



- Increase square footage to reduce crowding and create spaces for learning, making, creating, meeting, collaborating
- Neighborhood needs safe, experiential spaces to keep youth engaged and learning and to help foster increased literacy levels
- Address major building components to care for and protect this 20-year old facility

Ross-Barnum Branch Library



- Create new spaces for learning, making, creating, meeting and collaborating
- Transform the library into a true community hub, bringing together diverse populations in new and creative ways
- Connect non-English speaking residents with materials, services and spaces that foster community-building
- Neighborhood needs experiential space to keep youth engaged and learning

Schlessman Family Branch Library



- This 15-year old building is the second most visited library branch in Denver
- Increase square footage with an addition to provide community-centered spaces that are much needed in the growing Lowry neighborhood
- Reconfigure floor plans to create community spaces for learning, making, creating, meeting and collaborating

Eugene Field Branch Library



- Redesign the children's area to create a literacy rich play space where parents and young children come together to learn and read
- This modest-sized branch needs updating and reconfiguration to reduce crowding and provide spaces for learning, making and meeting
- Reconfigure technology areas to better reflect the ways customers access and use computers and online resources

Blair-Caldwell African American Research Library



- Preserve and protect this Five Points community center which serves as one of only two African-American research libraries in the U.S.
- Transform conference and community rooms into flexible, multi-function spaces for learning, making and collaborating
- Improve access to archives and historic documents for researchers while maintaining secure collections

Potential West Denver Recreation Center/Library



- Create a new facility to accommodate neighborhoods with little to no access to much needed cultural and recreational facilities and who need meeting and collaboration areas
- Create up to 20,000 square-foot library with spaces for learning, exploring, collaborating, making and community building
- Develop a children's area with literacy-rich play space where parents and young children can come together to learn and read

SURVEY RESPONDENTS

Three quarters of Denver County residents considered themselves library users



Self-reported
user of library

73%



Self-reported
card holder

75%



Visited* any
location 1+ times

78%



Visited*
website 1+ times

57%

When people think about Denver Public Library, one-third think about the Central Library

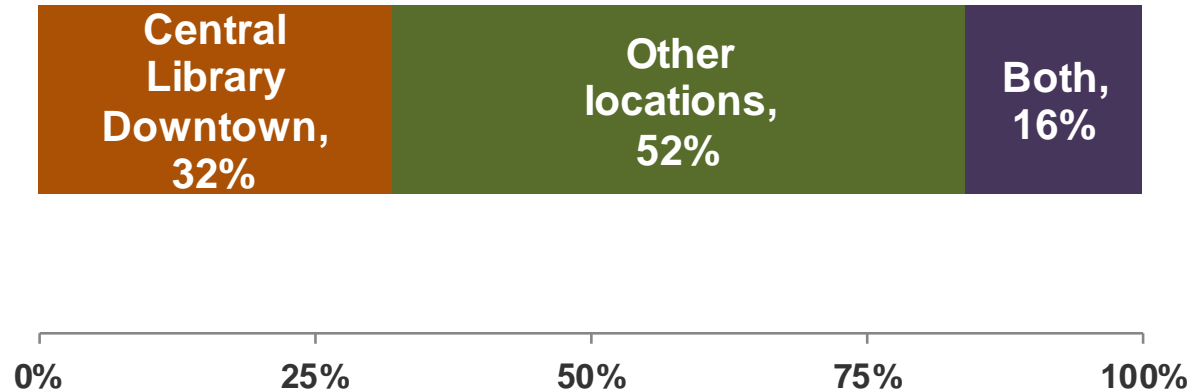

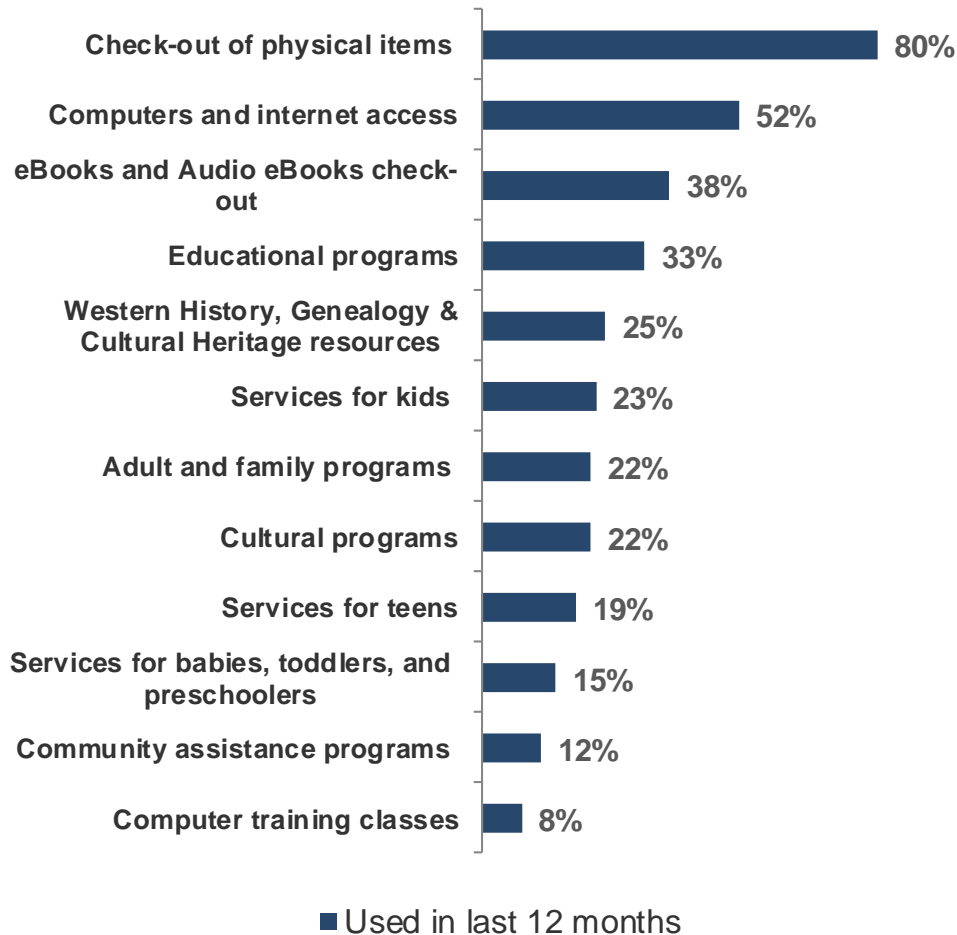

Checking out materials is still the number one use of the library.

Overall perceptions

Overall – positive

- 70% of residents had a “very positive” impression
- 20% had a somewhat positive; only 2% negative

Customers gave high marks to the library overall; staff were most highly rated

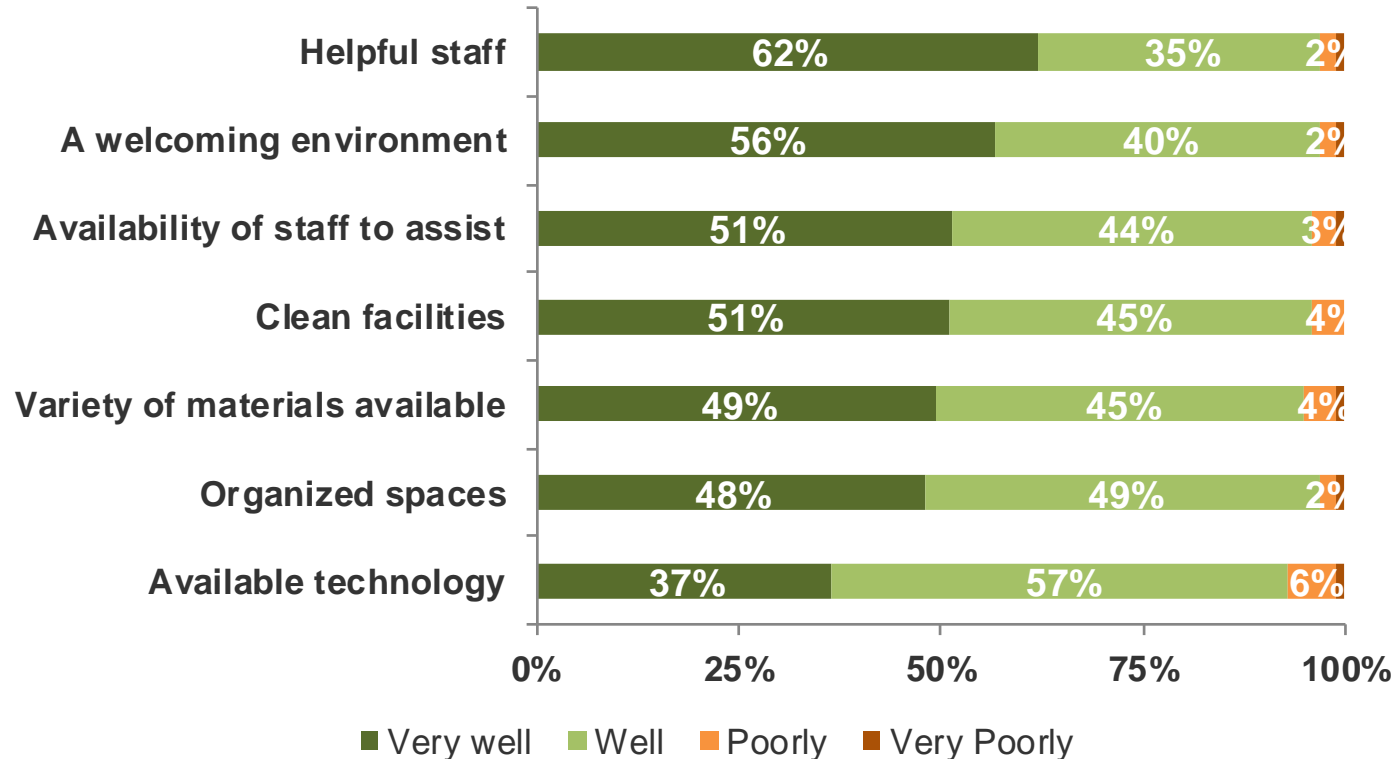

WHAT DO PEOPLE WANT TO KNOW?

Questions around future planning and services were most common among residents

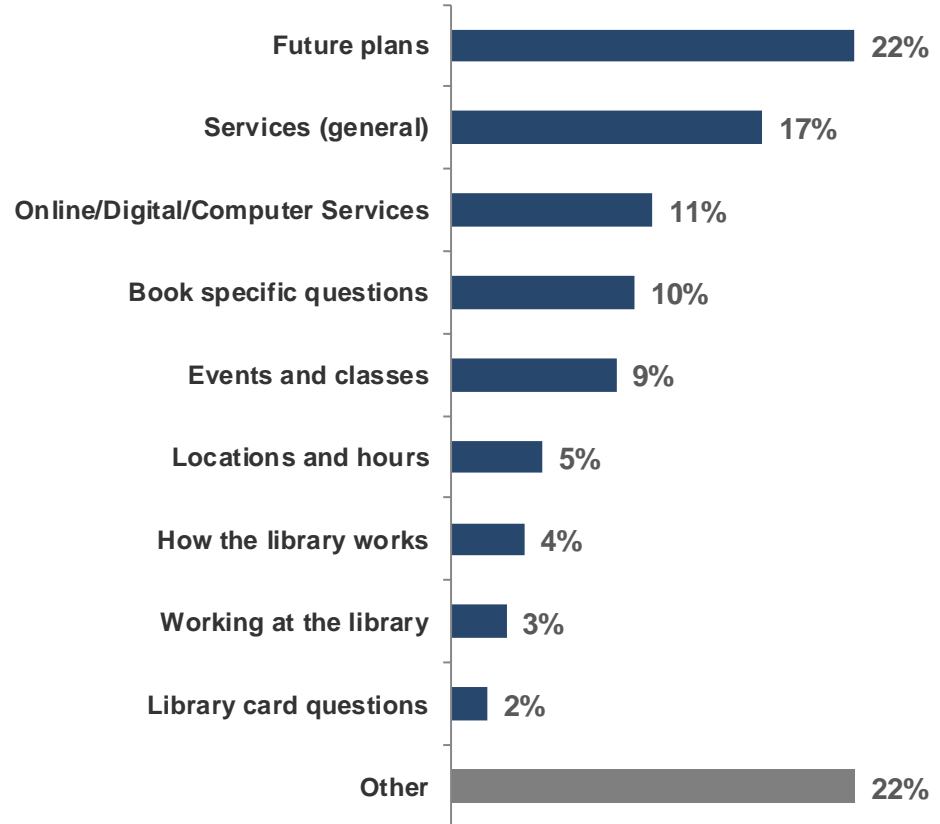



DENVER PUBLIC LIBRARY

What's in it for you?