



The New Denver Zoo FACILITY MASTER PLAN

March 2015



FACILITY ASSESSMENT 2011: Age of Building & Extent of Construction

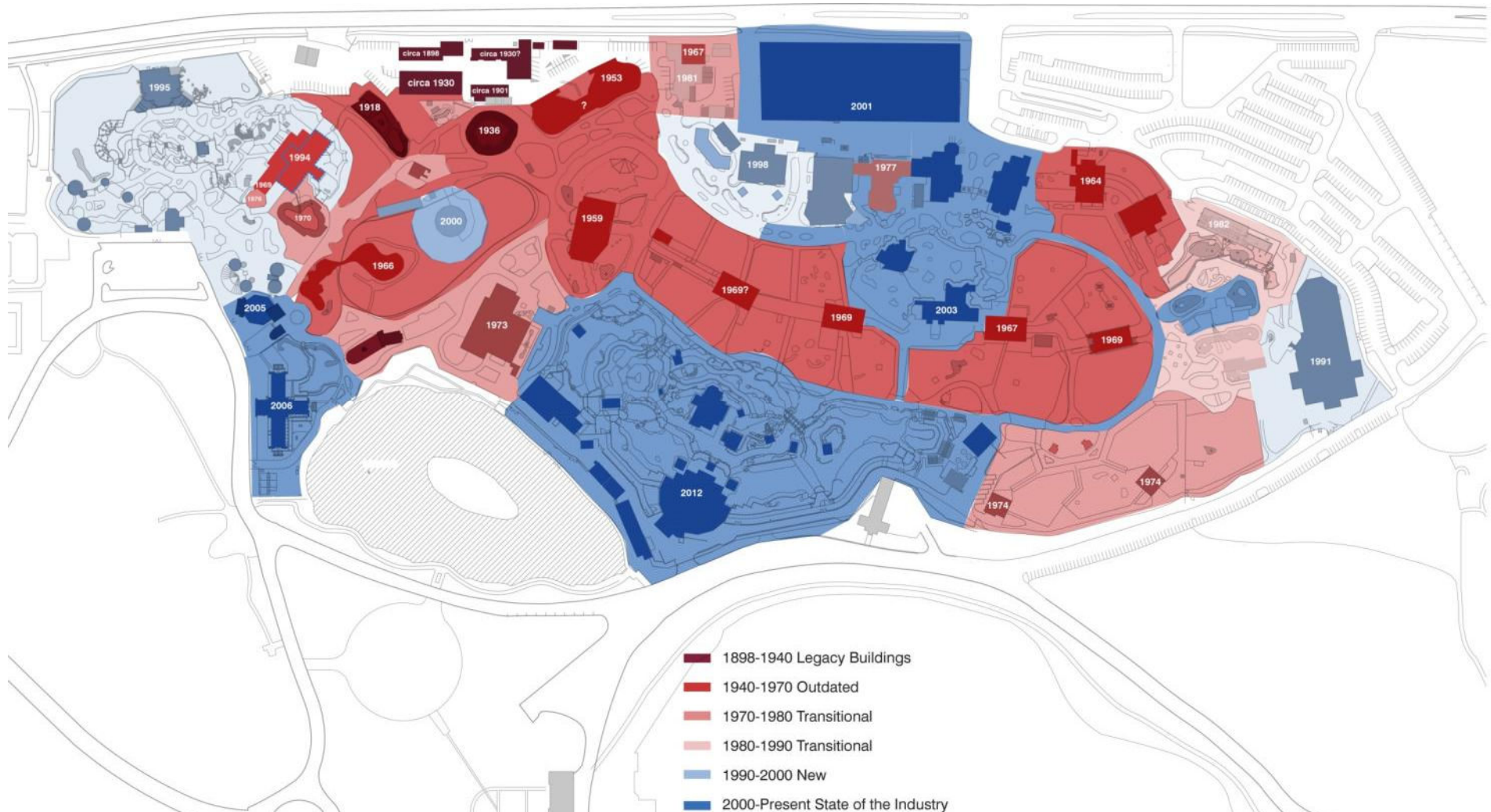

Building Age + Approximate Extent of Construction

Based on construction drawing research, the site extents of each building construction project are indicated in this map.

Approval Process

Community Engagement & Building Plan Approval

PARKS AND REC. PROCESS

- | | |
|------------|--|
| 01.26 | Master Plan Meeting with Zoo & DP&R |
| 01.28 | Design Charrette with Zoo & DP&R |
| 02.03.15 | CPFAN Meeting Presentation/Discussion |
| 02.04.15 | RNO's & INC Presentation/Discussion |
| 02.16-3.02 | Online Presentation with Feedback Module |
| 03.03.15 | Neighborhood Public Meeting @ Bogey's |
| 03.12.15 | DPRAB Presentation |

COUNCIL PROCESS

- | | |
|----------|---|
| 03.25.15 | Infrastructure and Culture Committee Meeting |
| 03.31.15 | Mayor/Council Meeting |
| 04.06.15 | City Council 1 st Reading |
| 04.13.15 | City Council 2 nd Reading/Public Comment |



COMMUNITY ENGAGEMENT: Public Forums and Feedback Opportunities



Public Forums and Feedback Opportunities

1. Denver Zoo hosted a series of **3** public forums facilitated by The Civic Canopy using real-time polling.
 - Total of **84** people attended the forums.
2. An interactive online module with a survey collected **479** responses.

What should be our highest priorities?

Weighted Responses to Overall Priorities

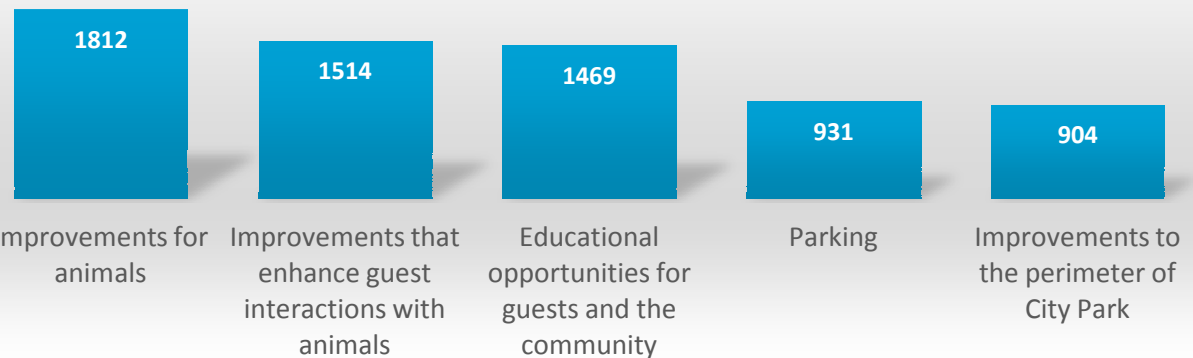

ONLINE PRESENTATION WITH FEEDBACK MODULE: 2/16/15 – 3/2/02

COMMUNITY ENGAGEMENT: What we learned



- **Exhibits:** high level of support for the current plans of exhibit design (4-4.5 stars on a 5 star scale).
- **Zoo/ Community Interface:** South perimeter improvements, including the Waste Management Building were a top priority for some neighborhood stakeholders but a lower priority for the other stakeholders, especially when compared to other zoo improvements.
- **Parking:** The level of concern varied widely and is considered a lower priority when compared to other improvements needed for animal exhibits.



COMMUNITY ENGAGEMENT: What we learned



Waste Management Building

- Activate and visually integrate into park

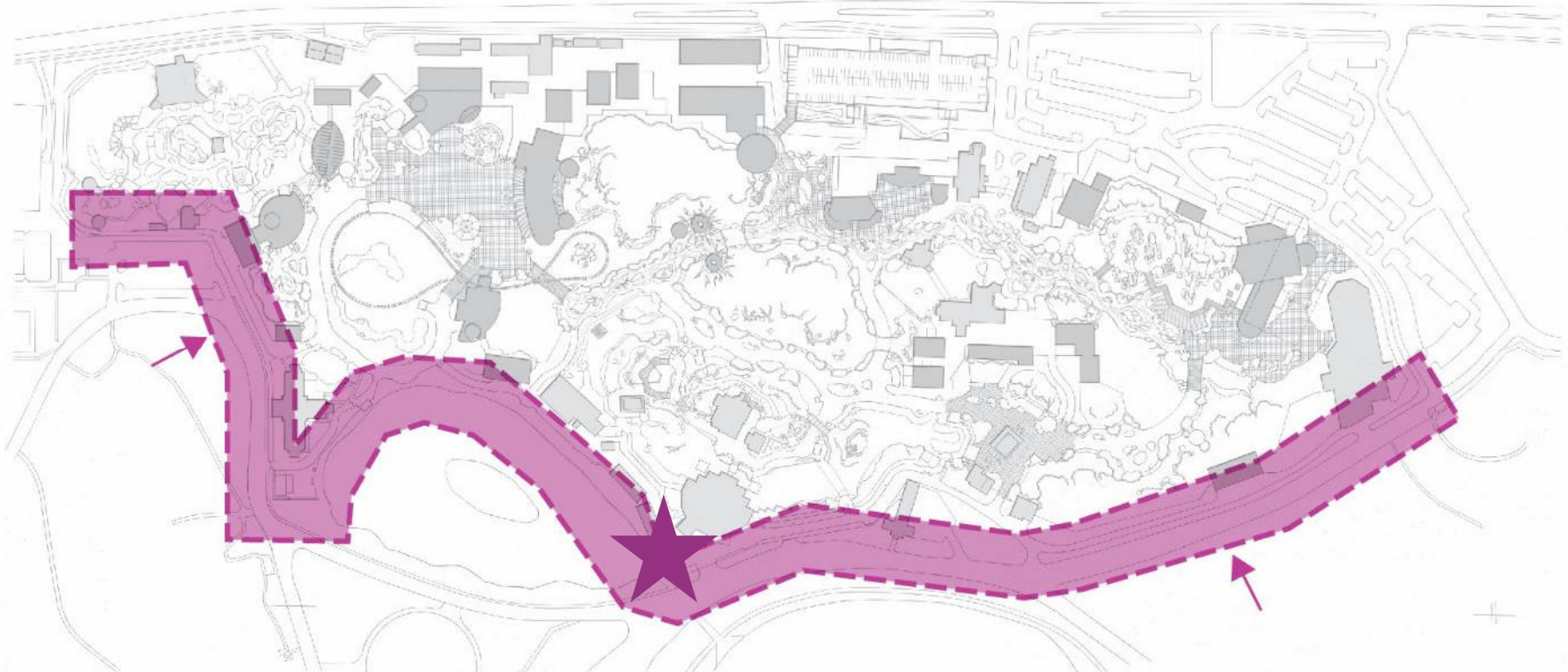

Existing



Mural



Art



Vines



Architecture



Plants and Trees

Building Plan Approval: Municipal Code

Sec. 39-210.

→ **[Buildings in excess of 3,000 square feet and over 35 feet tall require approval.]**

No building (as defined in the Denver Zoning Code) with a footprint in excess of three thousand (3,000) square feet or over thirty-five (35) feet in height shall be built in any city park unless it has been approved as part of a park building plan for such city park, or has been approved as part of a park plan adopted as part of the comprehensive plan pursuant to section 12-61 of this Code.

(Ord. No. 305-10, § 1, 6-7-10)

Sec. 39-211.

→ **[Building plan required]**

The manager of parks and recreation may submit to city council a park building plan for any city park. Such park building plan shall show, at a minimum, existing structures and open space and any proposed buildings with a footprint in excess of three thousand (3,000) square feet or that would be over thirty-five (35) feet in height, or any additions to existing buildings when the footprint of such addition is in excess of three thousand (3,000) square feet or the height of such addition is in excess of thirty-five (35) feet. Such buildings or additions need only be shown in the park plan as a maximum footprint, maximum height and a general location.



BUILDING PLAN APPROVAL: Denver Zoo Master Plan Building Plan

Denver Zoo Facility Master Plan 2015: Buildings over 3,000 sf and over 35' tall

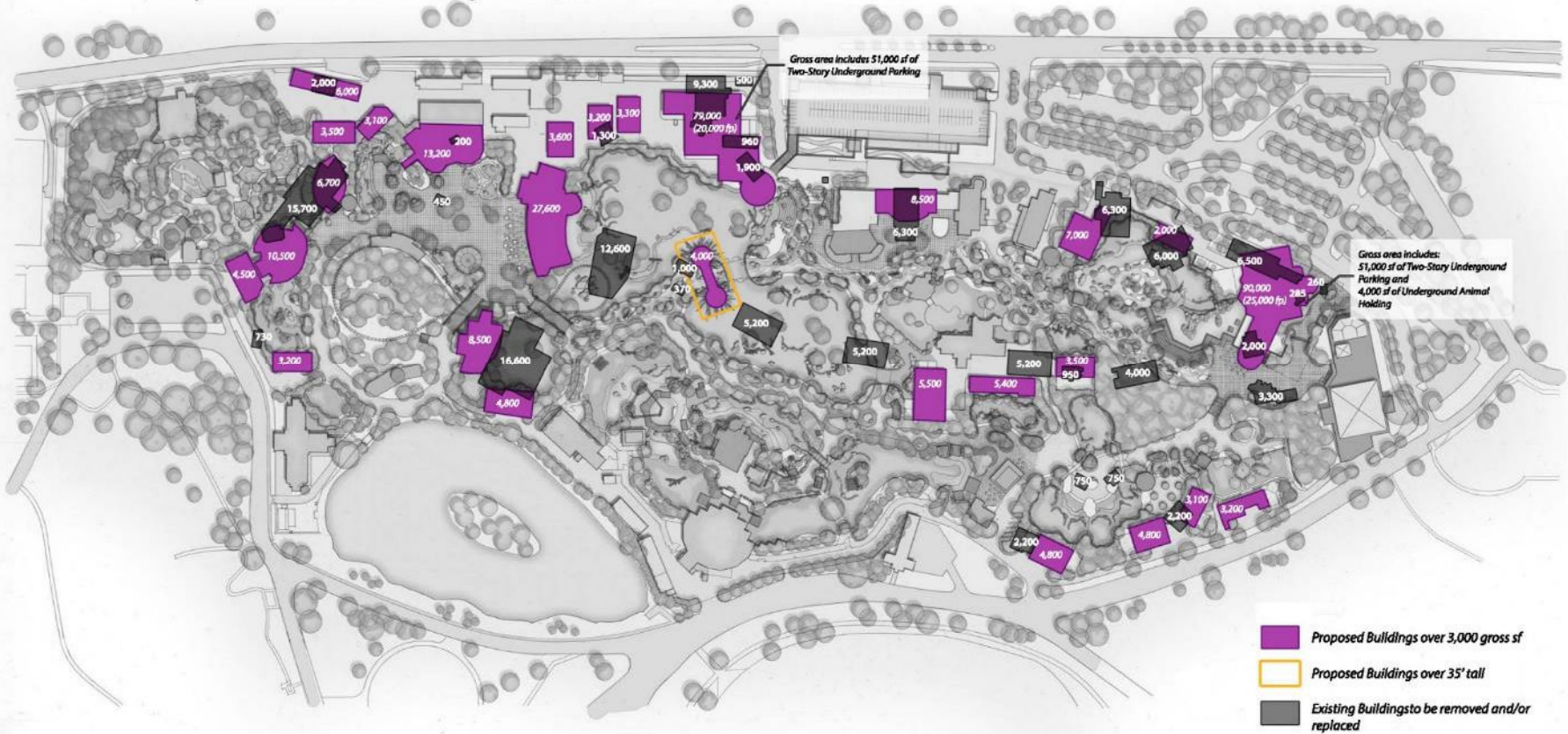

Building Plan: By the Numbers

EXISTING

Total Existing Buildings	71
<i>(Existing Buildings over 3,000)</i>	26

MASTER PLAN

Total MP Buildings Proposed	32
<i>(MP Buildings Proposed over 3,000sf)</i>	25
<i>(MP Buildings/Feature Over 35 feet)</i>	1

Total Existing Buildings Removed	32
<i>(Total over 3000 sf Removed)</i>	13

Net New Buildings	0
<i>(Net New Over 3000 sf)</i>	12

Total Buildings MP Build Out	71
<i>(Total MP Build Out Over 3,000)</i>	38



The image shows a title page for the Denver Zoo Master Plan. The background is a solid blue color. In the lower third of the page, there are two horizontal dotted lines. Between these lines, the text "DENVER ZOO MASTER PLAN" is centered in a white, bold, sans-serif font. Below the second dotted line, there is a decorative border consisting of a repeating pattern of white, stylized teardrop or leaf-like shapes.

DENVER ZOO MASTER PLAN

GUIDING PRINCIPLES

Animal Conservation

Connecting guests to our field conservation work promotes awareness of and compassion for threatened and endangered species. Sharing success stories in field conservation encourages positive action toward conservation and inspires guests to get involved.

Animal Care

Innovation paves the way to new standards in animal care. We will continue to create habitats and supporting areas that meet each animal's needs at all life stages: physically, mentally, and behaviorally. We prioritize the quality of animal facility programming over the quantity of animal species.

Veterinary Science

A premier program of veterinary medicine and surgery will enhance collaborations with local, national, and international professionals and students, including those at universities, teaching hospitals, specialty hospitals, and wildlife organizations. By becoming a resource in veterinary care through active engagement in research, we will advance zoological medicine.

Community

Denver Zoo is a part of City Park, of Denver, the nation and the world. We value the diverse communities in which we belong. As a part of Denver's City Park, we respect our neighbors and build upon the legacy of the Zoo within the park and strive to achieve the best physical and operational presence for all of the communities we serve.

Guest Experience

Experiences and moments which connect our guests to animals create lasting memories, inspire awe, and create life changing human and animal connections. Crafting these experiences and moments at a variety of scales throughout the zoo and for visitors of City Park is a priority in this plan.

Securing Our Future

Making meaningful connections between individuals and groups and supporting a strong relationship with the City and County of Denver is critical to a successful future. Creating positive relationships and an operating model that meets our needs will ensure future growth.

Education

Connecting guests to the natural world through recreation and learning inspires them to take action for animals and the environment. By utilizing Denver Zoo's Program Content Standards to define stories, environments, exhibit elements, and interpretation we will help guests achieve what we want them to know, feel, and do.

Sustainability

Connecting guests to the natural environment and sustainable ideas will inspire zoo visitors and communities to meaningfully reduce their environmental impact.



SITE PLANNING STRATEGIES

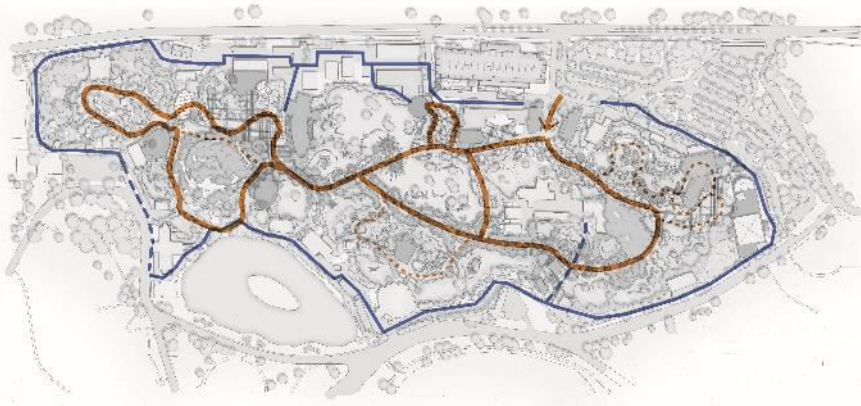

FLOW



LAND USE



BARN HUBS



VISITOR EXPERIENCE HUB

SITE PLANNING STRATEGIES

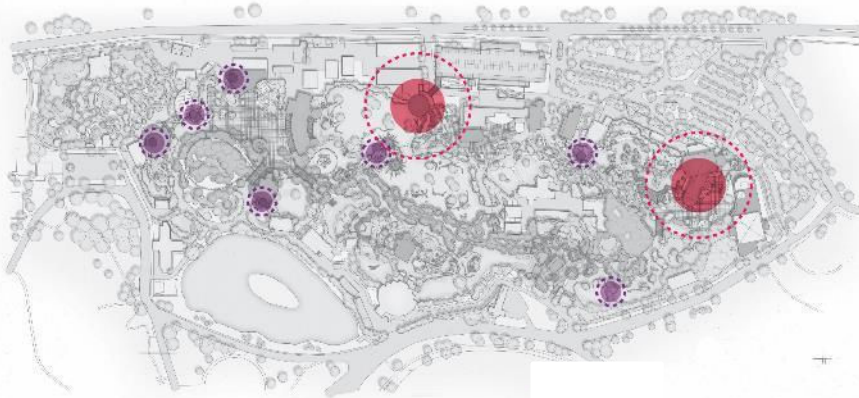

EDUCATION SATELLITES



CAMPUS ECOLOGY



PARK/COMMUNITY INTERFACE



MASTER PLAN PROJECTS

THE NEW DENVER ZOO: FACILITY MASTER PLAN 2015



1. **African Savanna**
(including the Watering Hole, West Portal, Vet. Hospital)
2. **Coastal** *(including the East Portal)*
3. **Denver Zoo Into the Wild: Peaks to Prairie**
4. **Asian Highlands & Predators**
5. **Braided Path**
6. **Zoo Perimeter Improvements**
(including parking)



**MASTER PLAN
PROJECTS**



1. AFRICA

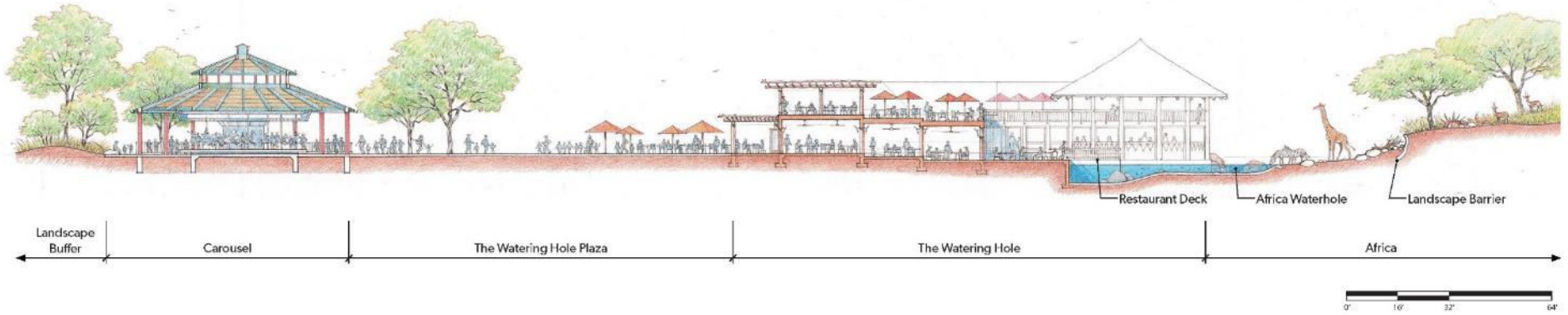

Candidate Species

Black rhinoceros, giraffe, Grevy's zebra, gerenuk, okapi, bongo, ground hornbills, storks, vultures, waterfowl, and cranes

2. COASTAL

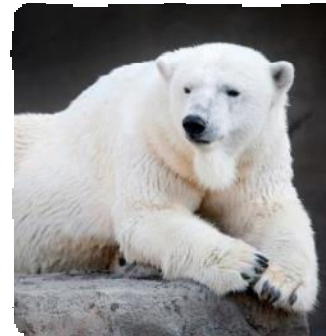
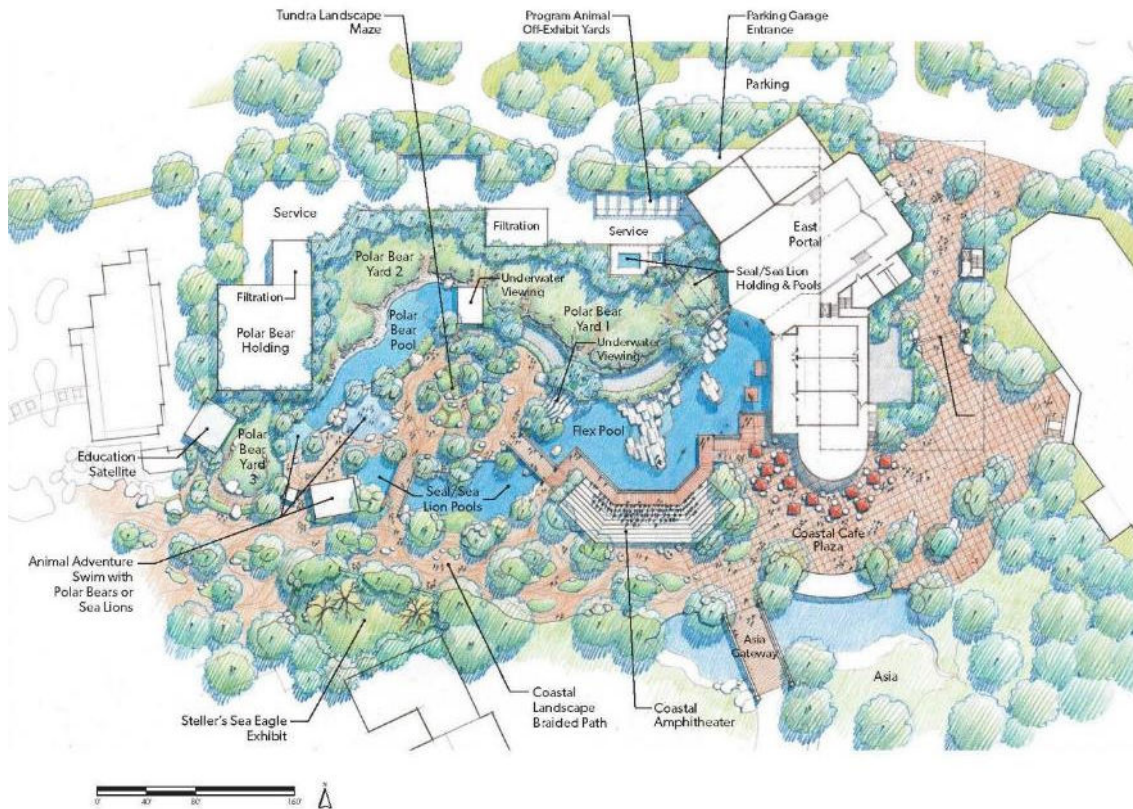
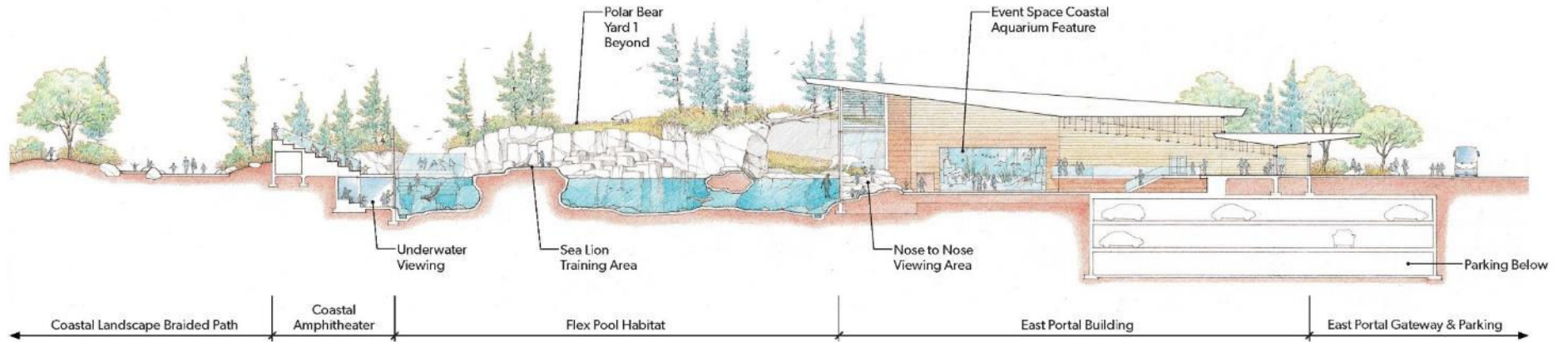

Candidate Species

Exhibit: Polar bears, sea lions, harbor seals, and Steller's sea eagles
 East Portal Aquarium: Salmon or trout, Arctic char, eel, catfish, crayfish

3. DENVER ZOO INTO THE WILD: Peaks to Prairie

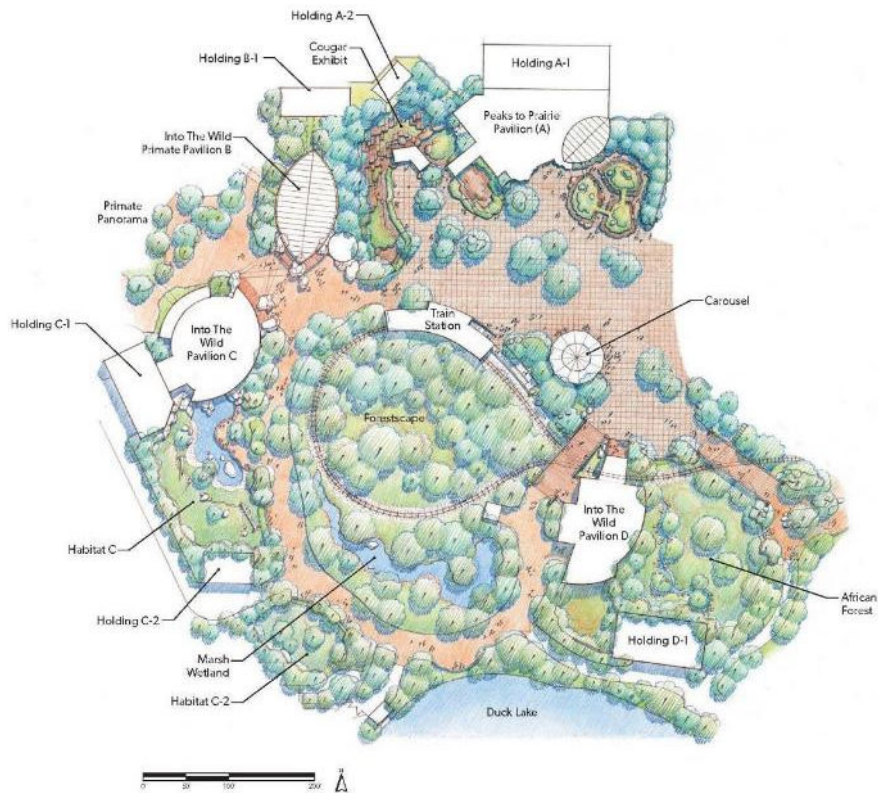
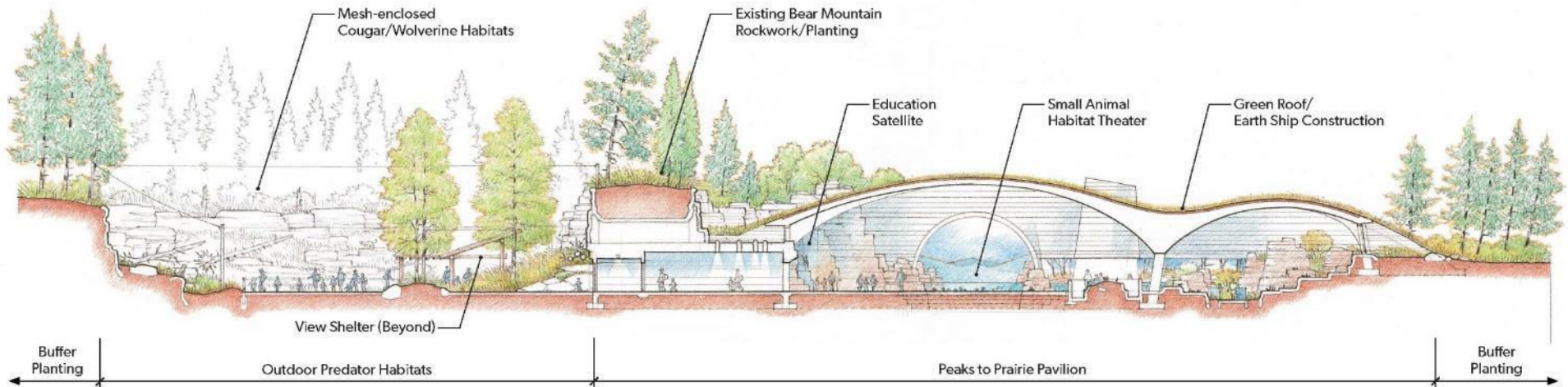

Candidate Species

Prairie ecosystems: prairie dogs, black-footed ferrets, burrowing owls, and reptiles
 Mountain ecosystems: mountain lion, lynx or wolverine
 Riparian ecosystems: beaver, river otter, fish

4. ASIAN HIGHLANDS

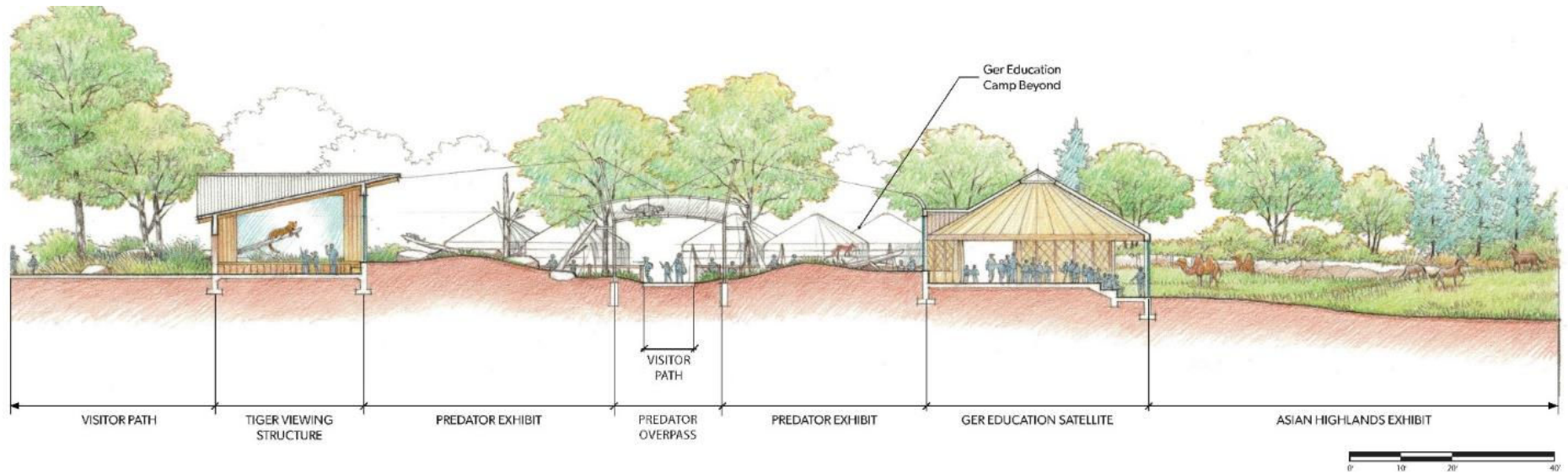

Candidate Species

Amur tiger, snow leopard, Amur leopard, takin, Prezwalski's horse, Pallas Cat, Bactrian camel, sloth, cinereous vulture, bustards, and cranes

5. BRAIDED PATH

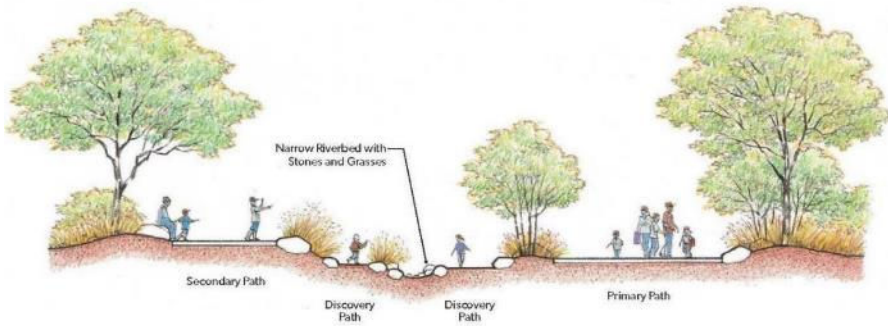

Candidate Species

Kids exploring, learning, crawling, investigating, laughing, playing

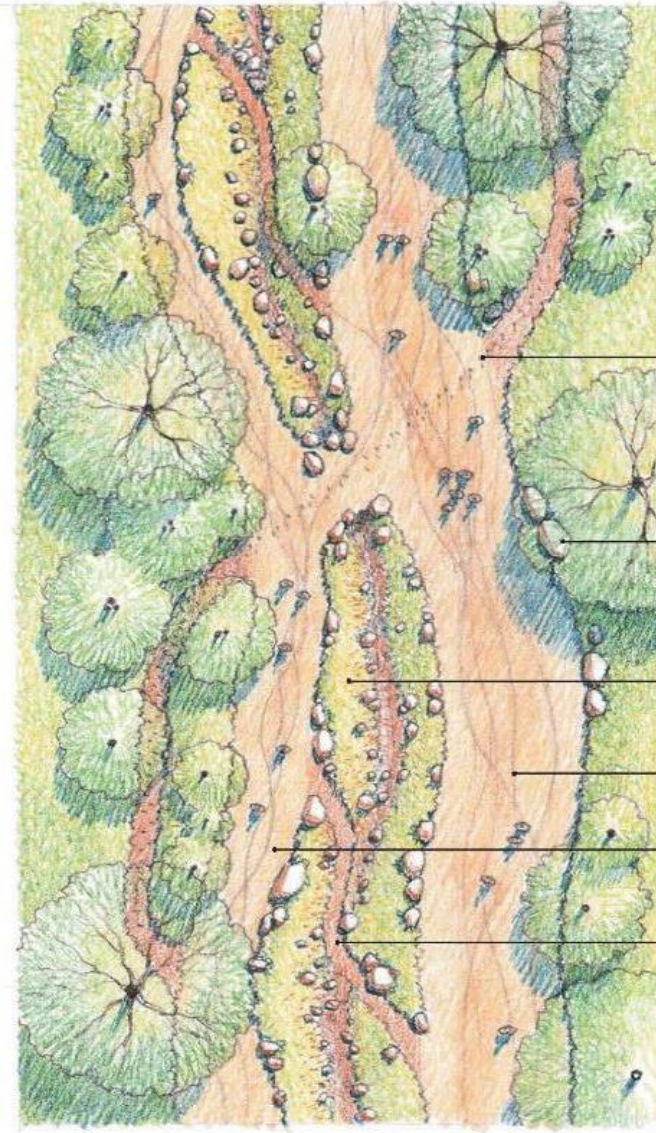

6. Zoo Perimeter Improvements: Parking, Zoo Architectural Fence, WM Building

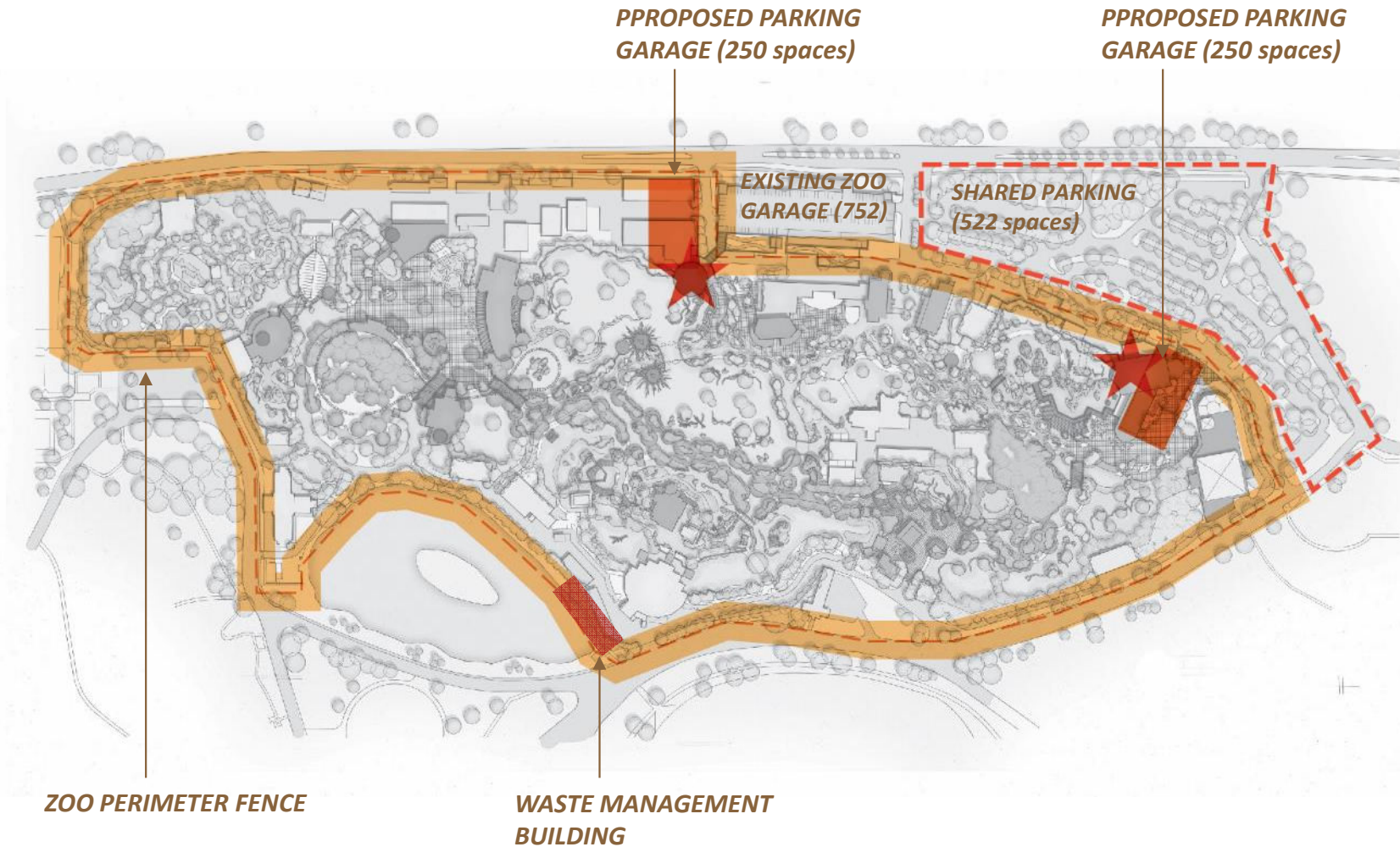

 **EAST AND WEST PORTAL PROGRAM ENTRANCES**





THANK YOU!