

A stylized map of North America in shades of blue. A black dot is placed over the location of Denver, Colorado, with the word "DENVER" written in a bold, sans-serif font to its right.

● DENVER

South Terminal Redevelopment Program

Terminal Bridges Levels 4, 5 and 6 West and Level 5 East
Reconstruction

March 7, 2012



DENVER INTERNATIONAL AIRPORT
TOGETHER WE SOAR

Level 4, 5, 6 Bridge Reconstruction

- Level 4 and 6 Terminal West bridges (2012)
- Level 5 Terminal West and East bridges (2012)
- Level 4 and 6 Terminal East bridges (2013)



Level 4, 5, 6 Bridge Reconstruction

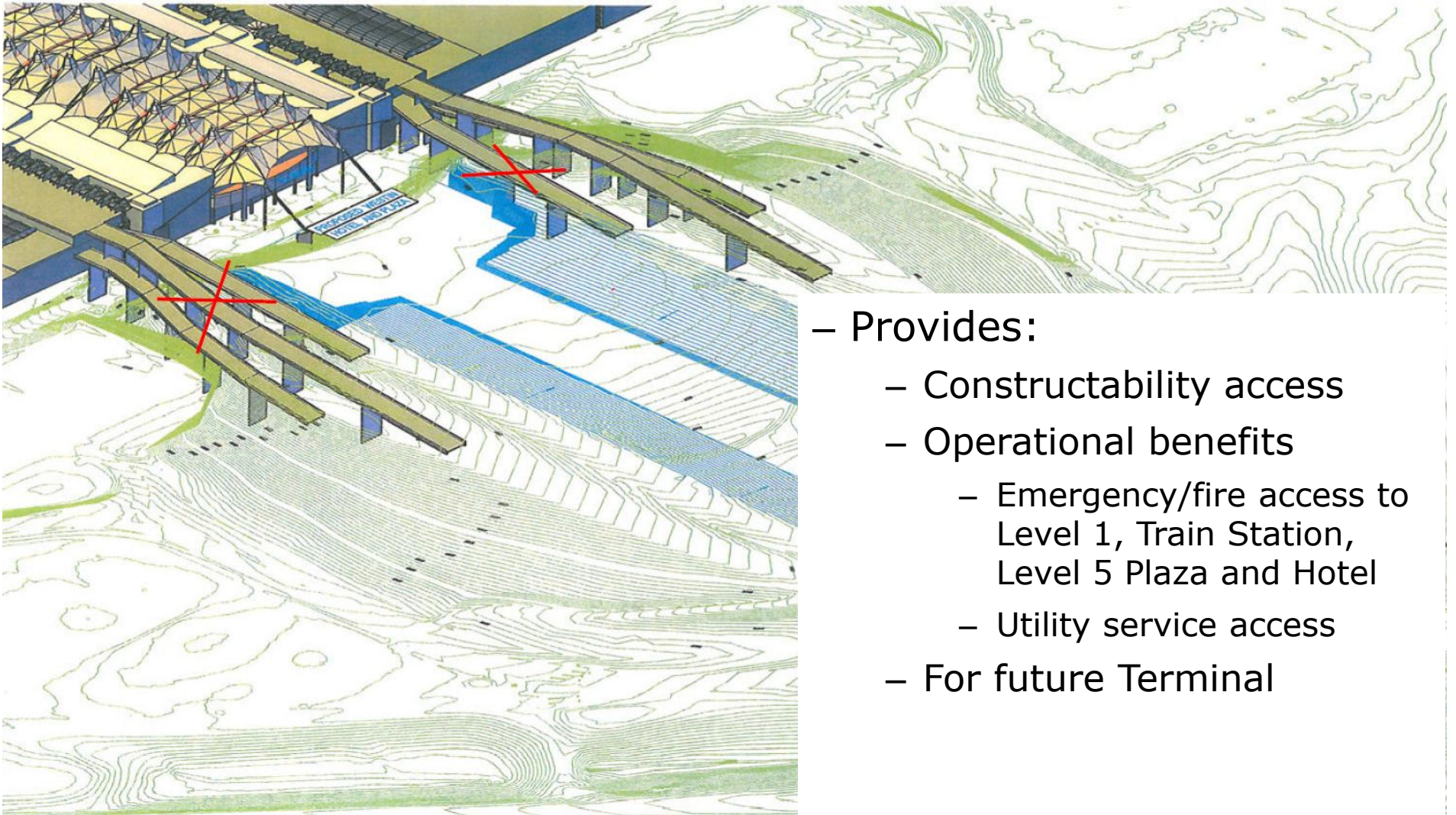

- Provides:
 - Constructability access
 - Operational benefits
 - Emergency/fire access to Level 1, Train Station, Level 5 Plaza and Hotel
 - Utility service access
 - For future Terminal

Final Program Roadways

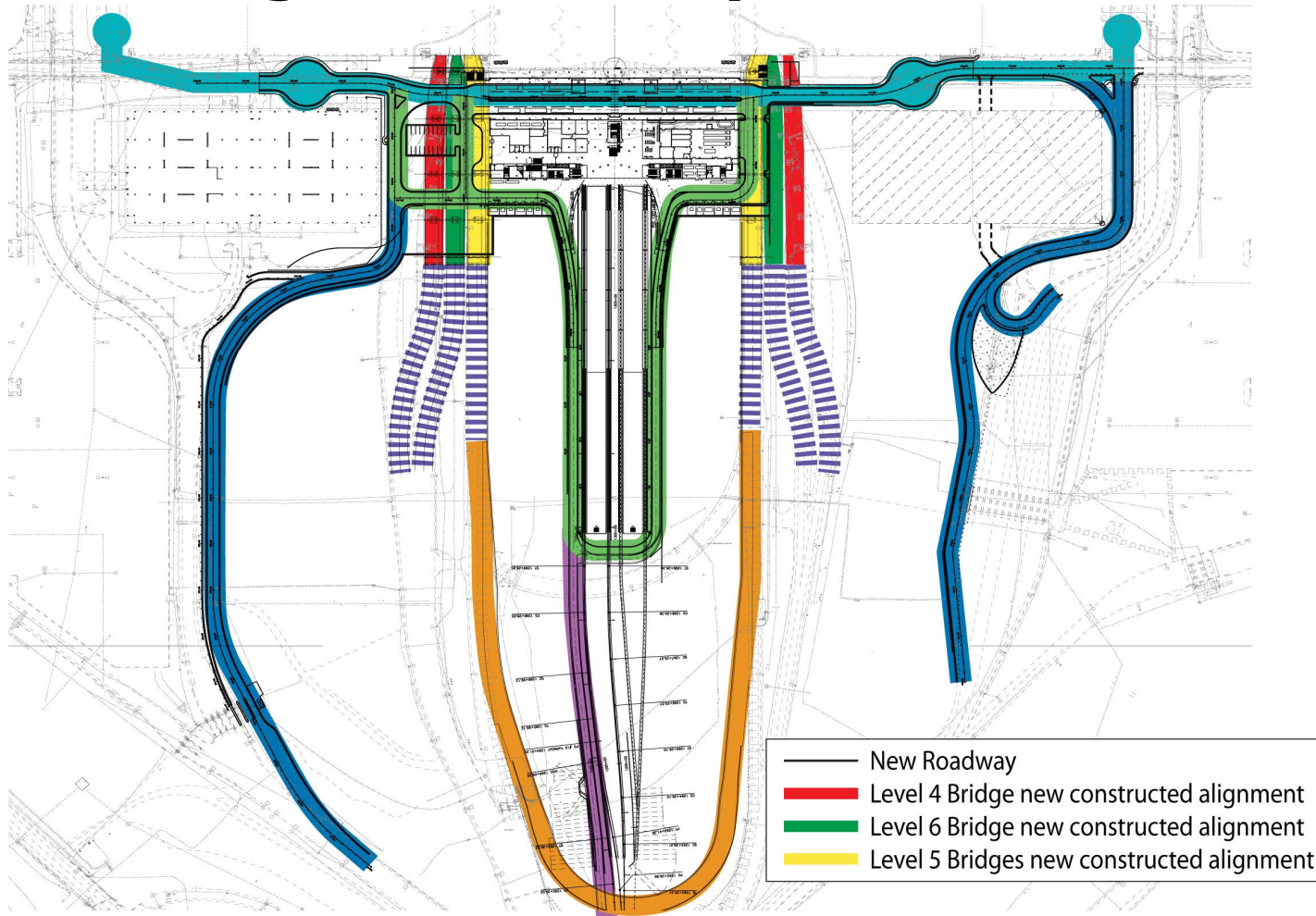

Construction Schedule

DENVER

ELEMENT	CLOSURE DATE	DURATION	IMPACTED STAKEHOLDER
T1 Road	Closed	End of program	Ground transportation, parking, traveling public
Patio	Effective immediately	Permanent	Traveling public and employees
Level 5 East	April 12, 2012	20 months	Ground transportation, RTD, airlines, employees and traveling public
Level 5 West	April 12, 2012	9 months	Ground transportation, RTD, airlines and traveling public
Level 4 West	April 25, 2012	11 months	Traveling public and airlines
Level 6 West	April 25, 2012	10 months	Traveling public, employees and airlines

5

Level 4 – Arrivals Level Pick-up

- Terminal West Level 4 bridge closes 4/25/12
- Opens mid 2013
- Arrivals (passenger pick-up) detoured through garage to Level 4 West

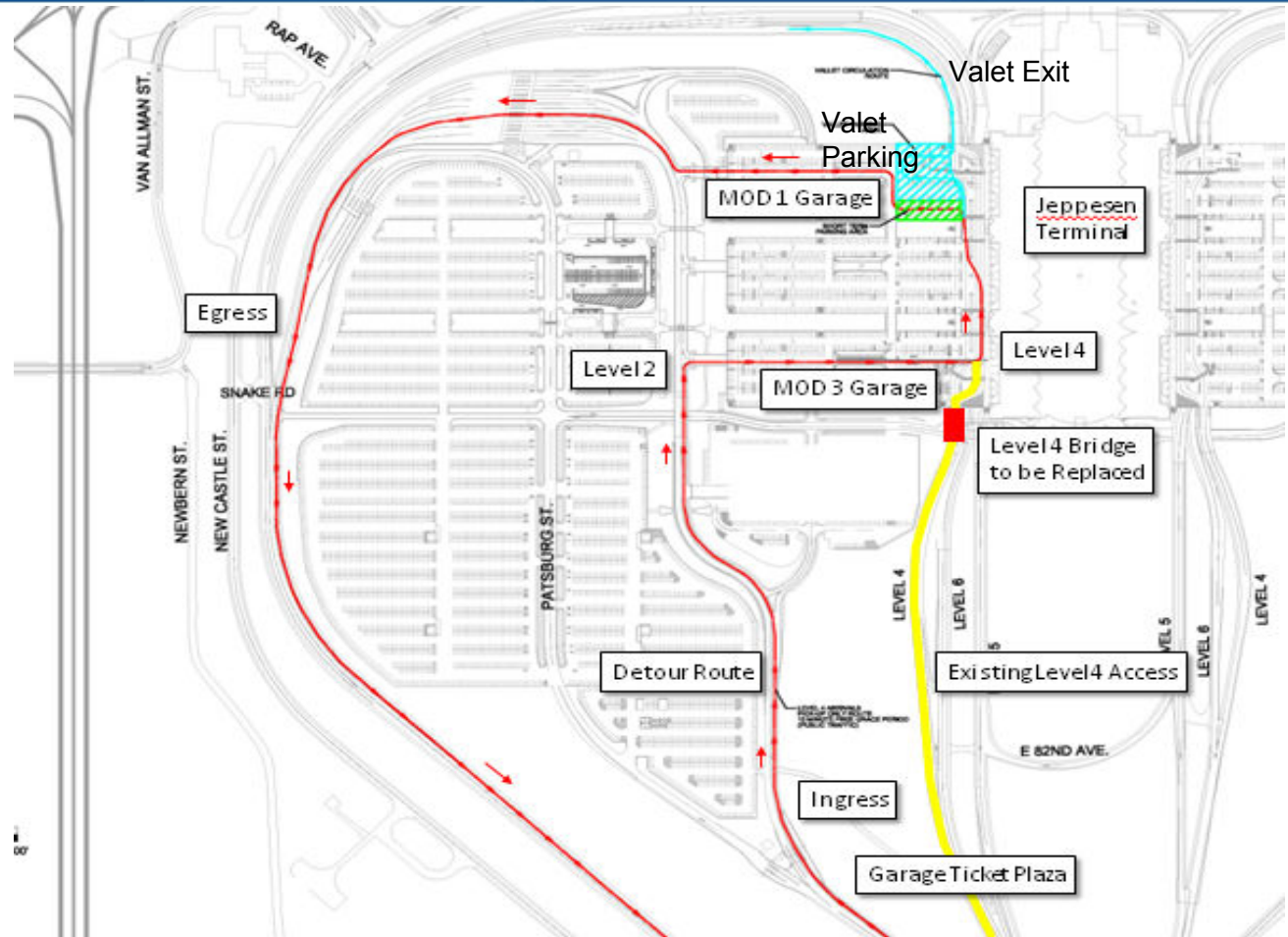

Level 6 – Departures Level Drop-off

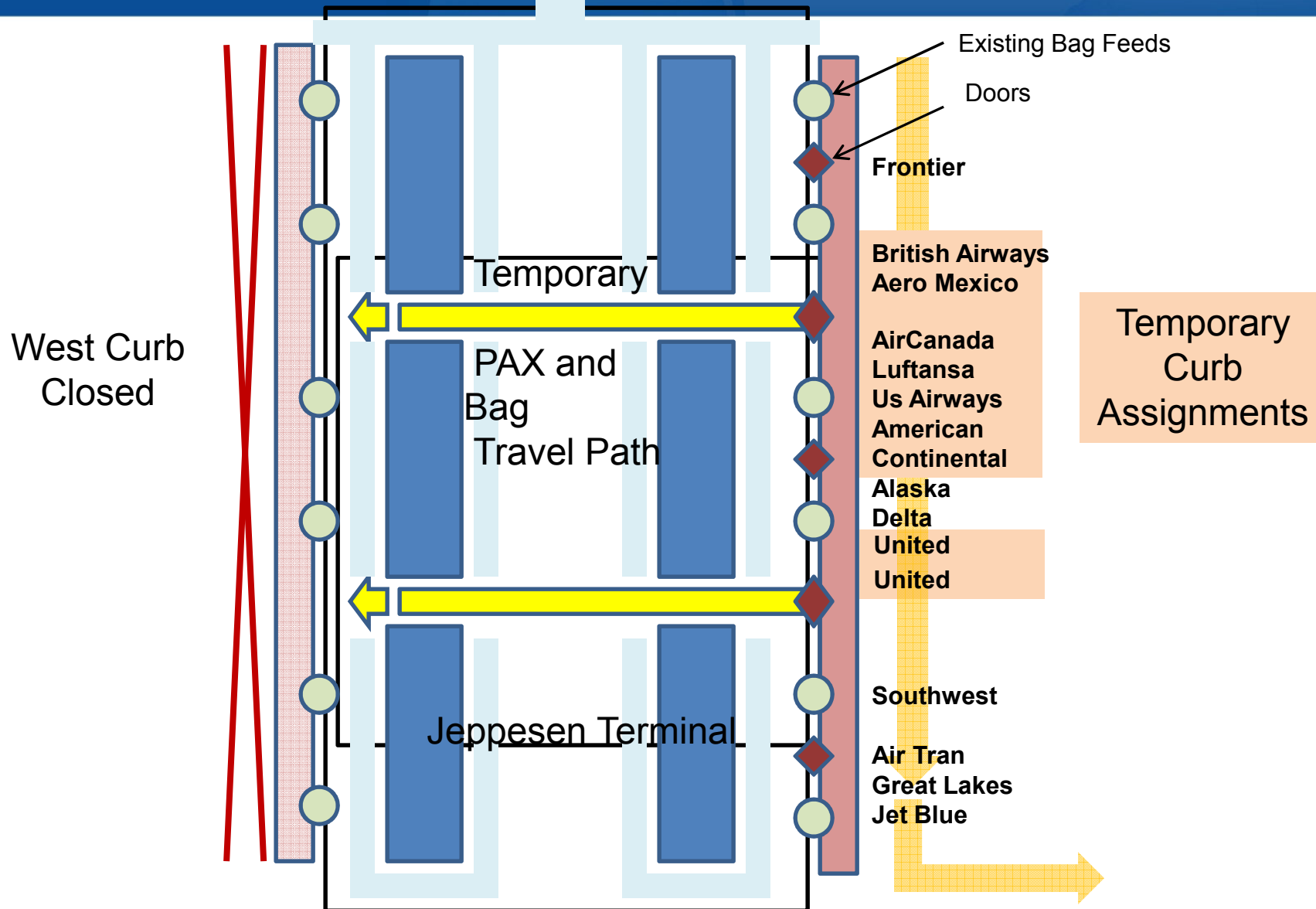

Communications Tools

DENVER

Audience	Tool
Media	<ul style="list-style-type: none">• Press Conference• Taped segments and live shots day of closure• Reminder press releases and banner scroll
Traveling Public	<ul style="list-style-type: none">• Radio traffic spot ads (CO, WY, NE, KS)• TV traffic spot ads• RTD bus (regional, Skyline) ads• DIA ads in each of the concourses• Flyers at parking exit lanes, passenger check-in, information booths, ambassadors, concessions• Cling signage for elevators, sliding doors and at baggage claim• Interior directional signage• Roadway signage/VMS/Overhead• Update, detours, queue waits, airline curbside locations on www.flydenver.com and Facebook page• Program hotline, twitter updates, DIA radio

Communications Tools

DENVER

Audience	Tool
Ground Transportation	<ul style="list-style-type: none">• Flyers for all offices (rental car agencies, taxi depots, etc.)• Email updates from DIA and station managers,
Employees and other internal stakeholders	<ul style="list-style-type: none">• All hands email, intranet updates, all-hands division and EOC briefings• Manager phone call or Manager's meeting, DEN Employee News• Flyer for new employee drop-off and cling signage for shuttle bus windows• Emails and flyers for distribution to airlines, concessions and tenants employees and PPSO
Origin/Destination Entities (hotels, events, resorts, travel agents)	<ul style="list-style-type: none">• Outreach letter/emails• Outreach to airlines/travel websites to insert update line in bookings, tickets• Email update and flyers to include with event/hotel information/tickets

9

Staying Informed

DENVER

- Program information line:
[303-542-7172](tel:303-542-7172)



- Visit:
www.flydenver.com



- Program email:
southterminalupdate@flydenver.com



10