

Avion at Denver Connection Neighborhood Park Naming

EXISTING
POCKET PARK

SPORT
COURT

PLAYGROUND

PARK STRUCTURE
(TRELLIS & SEATING)

ELK PLACE

PICNIC AREA

City and County of Denver
Denver City Council

October 6, 2025

5:30 p.m.

MULTI-USE
TURF FIELD

BUFFER PLANTINGS

EXISTING
DOG PARK

PARKING

PORTABLE
RESTROOMS

ON STREET PARKING

JASPER STREET

BOLLING DRIVE

KITTRIDGE STREET

SLOPE/GRADE
CHANGE

SLOPE/GRADE
CHANGE





Denver Parks & Recreation

KENT SONDERGATH

DESIGN & CONSTRUCTION

SUPERVISOR

JENNIFER CERVERA

DEVELOPMENT REVIEW

STEPHANIE WONG

PROJECT MANAGER

LAURA MORALES

DPR ADMINISTRATOR



Norris Design

BRAD HAIGH

PRINCIPAL

ALYSSA BUTLER

SENIOR ASSOCIATE

CHAD PURCELL

ASSOCIATE LANDSCAPE DESIGNER

Avion Metropolitan District

(f/k/a Denver Connection West
Metropolitan District)

MARC ROBSON

PRESIDENT

SHAWN HAMPLETON

VICE PRESIDENT

TINA WOODARD

SECRETARY

RACHELLE WEIGOLD

TREASURER

**INDEPENDENT DISTRICT ENGINEERING SERVICES
LLC (IDES)**

TIMBERLINE DISTRICT CONSULTING

MCGEADY BECHER CORTESE WILLIAMS P.C.

With special thanks to:

Councilwoman Stacie Gilmore, Lewis Tallbull, Ester Perez, Rick Waters,
Scott Gilmore, and Trennie Burch

PROCESS WITH DENVER PARKS

01 PARTNERSHIP WITH METRO DISTRICT
AND DENVER PARKS

02 DEVELOPMENT AGREEMENT



Approved by City Council and Executed in 2024

03 FINAL CONSTRUCTION DOCUMENTS
AND CONSTRUCTION



Contract Awarded in Spring 2025; Construction Underway!

04 PARK NAMING

Final vote and approval of formal name tonight!

05 ESTABLISHMENT PERIOD

06 TRANSFER TO DENVER PARKS

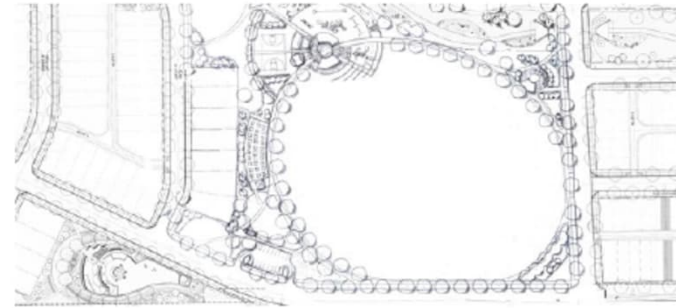

Illustrative Plan



3D Renderings



3D Renderings



Amache Ochinee Prowers

- Ameohtse'e (Amache/Walking Woman) was the daughter of O'kenehe (Ochinee/One-Eye), a prominent Cheyenne Chief who was murdered during the Sand Creek Massacre in 1864
- Known as an activist, a mediator, and a bridge between cultures
- Married John Prowers in 1861, moved to Bent's Fort and opened a trading store in Boggsville
- Testified in Congress regarding reparations related to the Sand Creek Massacre
- Received land grants along Arkansas River to establish one of the largest ranches in the area
- Maintained Cheyenne traditions, including language, and culinary and medicinal recipes
- Inducted into Colorado Women's Hall of Fame in 2018



Amache Prowers Memorial Park

- Would be the **FIRST** park in the City and County of Denver to carry an Indigenous or American Indian name
- **Trennie Burch** of the Denver American Indian Commission suggested naming the park in memory of Amache Prowers
- Naming the park in memory of Amache Prowers would be a tribute to her efforts in bridging cultural divides, along with her leadership in her family's business and advocacy for Native American rights and symbolizes the resilience and unity that parks often represent
- In addition, "a park bearing her name would be a tribute to her dedication to cultural understanding, community leadership, and her role in shaping the American West"





Amache Prowers Memorial Park