

# GREEN VALLEY RANCH FILING NO. 62

A RESUBDIVISION OF A PART OF LOT 1, MOFFITT TRACT AND A PART OF THE NORTHWEST QUARTER OF SECTION 15, TOWNSHIP 3 SOUTH, RANGE 66 WEST OF THE SIXTH PRINCIPAL MERIDIAN, CITY AND COUNTY OF DENVER, STATE OF COLORADO.  
SHEET 3 OF 11

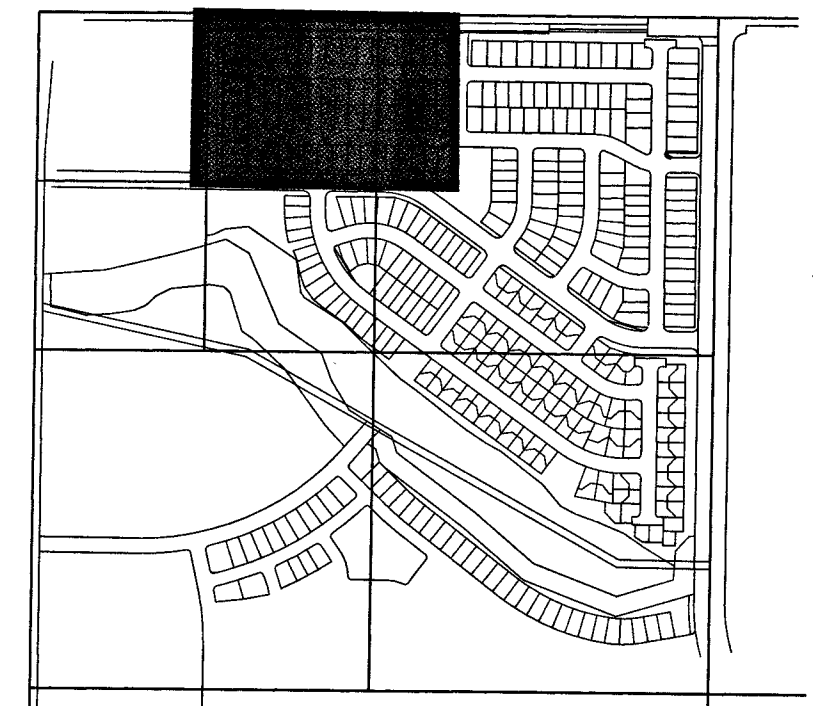

KEY MAP  
NOT TO SCALE

CURVE TABLE			
CURVE	DELTA	RADIUS	LENGTH
C1	89°36'46"	50.00'	78.20'
C2	90°00'00"	25.00'	39.27'
C3	90°00'00"	25.00'	39.27'
C4	90°00'00"	15.00'	23.56'
C5	90°00'00"	15.00'	23.56'
C6	90°00'00"	15.00'	23.56'
C7	90°00'00"	15.00'	23.56'
C8	90°00'00"	15.00'	23.56'
C9	90°00'00"	15.00'	23.56'
C10	90°00'00"	25.00'	39.27'
C11	90°00'00"	15.00'	23.56'
C12	90°00'00"	15.00'	23.56'
C13	90°00'00"	15.00'	23.56'

LINE TABLE		
LINE	BEARING	LENGTH
L8	N89°50'00"E	16.00'
L9	N00°10'00"W	32.00'

**UTILITY LEGEND**

- (A) 5' UTILITY EASEMENT GRANTED BY THIS PLAT
- (B) 8' UTILITY EASEMENT GRANTED BY THIS PLAT
- (C) ACCESS AND UTILITY EASEMENT GRANTED BY THIS PLAT
- (D) 5' SIDEWALK EASEMENT GRANTED BY THIS PLAT

**MONUMENT LEGEND**

- ◆ FOUND SECTION CORNER AS NOTED
- ▲ FOUND 1" BRASS TAG STAMPED LS 22561
- RANGE POINT: MONUMENT TO BE SET BY OTHERS IN A RANGE BOX AFTER CONSTRUCTION OF THE STREETS.

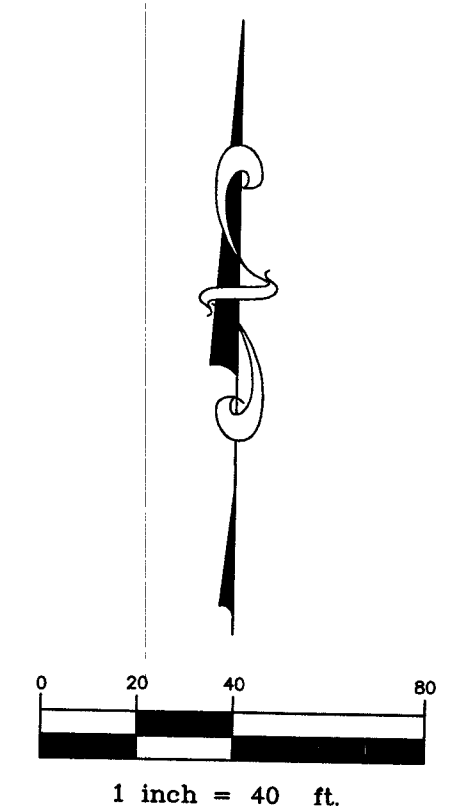

(SEE SHEET 4)

(SEE SHEET 6)

(SEE SHEET 5)

**AZTEC CONSULTANTS, INC.**  
300 East Mineral Ave., Suite 1  
Littleton, Colorado 80122  
Phone: (303) 713-1898  
Fax: (303) 713-1897  
www.aztecconsultants.com

**DEVELOPER**  
OAKWOOD HOMES  
4908 TOWER ROAD  
DENVER, COLORADO 80249-6684  
(303) 486-8500

DATE OF PREPARATION:	2015-06-17
SCALE:	1" = 40'
SHEET 3 OF 11	

Aztec Proj. No.: 19315-14