



NATIONAL WESTERN CENTER

Denver City Council | Budget and Policy Committee

May 9, 2022



AGENDA

- Introductions
- Campus Construction Updates and Next Steps
- National Western Center Authority Updates



ROLES AND RESPONSIBILITIES



Mayor's Office of the National Western Center is responsible for construction of the campus, holds the lease and is the principal landowner.



The NWC Authority is responsible for programming and maintaining the campus for the next 100 years.



The Western Stock Show Association is building their own headquarters, the Legacy Building, and will continue to host the Stock Show, Denver County Fair and All-Star Rodeo.



The CSU Spur campus is made up of 3 buildings focused on food, water and health and will be a hub for research related to important world issues and be open to the public as a place for experiential education.

NWC CAMPUS PLAN

1. RTD Transit Station
2. Brighton Blvd. – 47th to Race Court
3. South Platte Riverfront
4. New National Western Drive
5. Stockyards Event Center
6. The Yards Multi-Use Space
7. Campus-related transit-oriented development (TOD)
8. New Bridges Near 48th & 51st Avenues
9. Livestock Center
10. Equestrian Center
11. District energy system's central utility plant (CUP)
12. CSU Spur: Vida (health)
13. CSU Spur: Hydro (water)
14. CSU Spur: Terra (food)
15. Maintenance & Operations Facility
16. DRIR Rail Corridor
17. WSSA Legacy Building HQ
18. Pedestrian Bridge
19. Arena
20. Expo Hall
21. 1909 Building rehabilitation
22. Supporting development

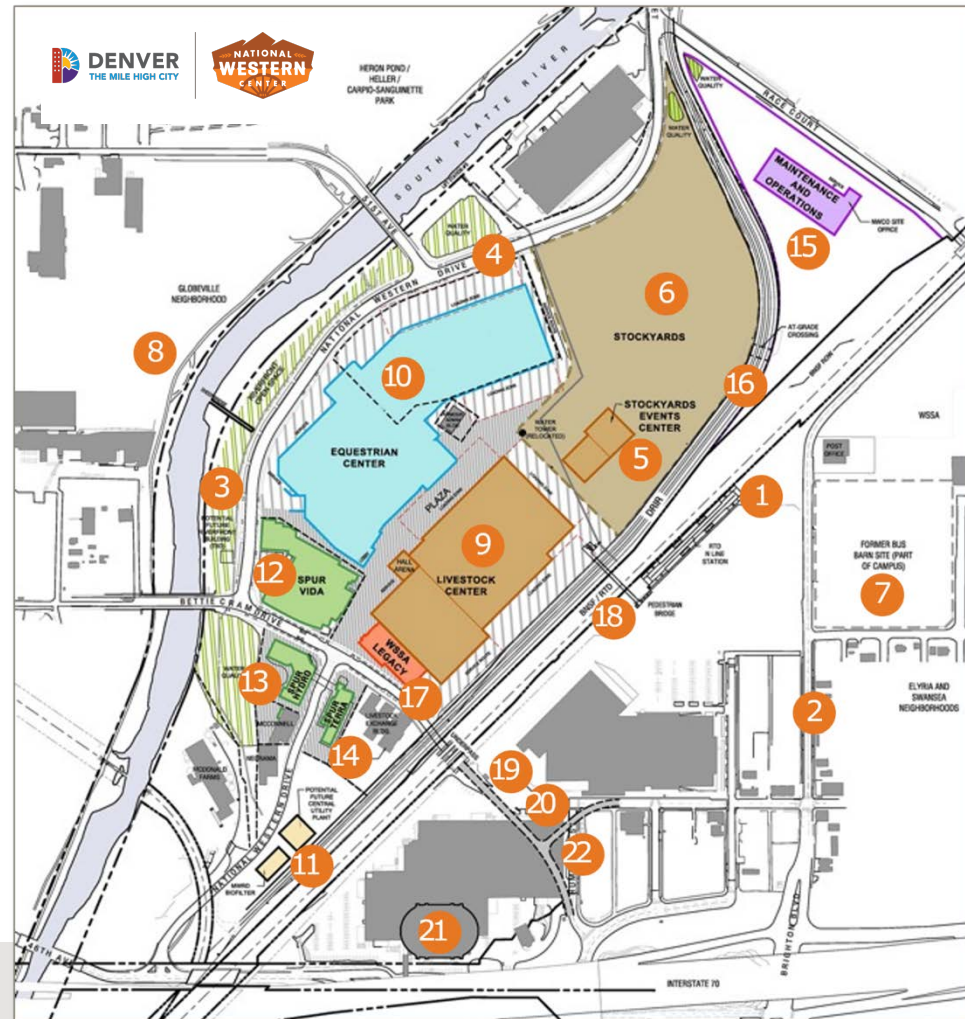

PHASE 1 & 2 PROGRAM STATUS

WORK COMPLETED



DENVER
THE MILE HIGH CITY



PHASE 1 & 2 PROGRAM STATUS

WORK COMPLETED

- Sitewide Land Preparation

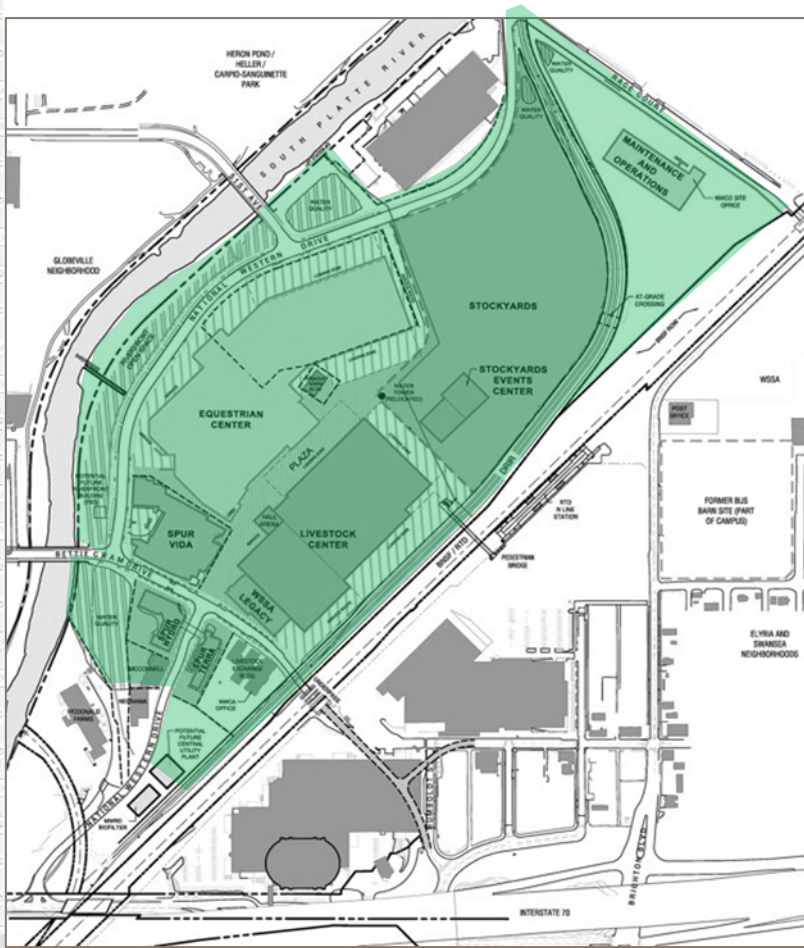

PHASE 1 & 2 PROGRAM STATUS

WORK COMPLETED

- Sitewide Utilities
- Major Drainage and Water Quality Facilities



PHASE 1 & 2 PROGRAM STATUS

WORK COMPLETED

- Maintenance and Operations Building



PHASE 1 & 2 PROGRAM STATUS

WORK COMPLETED

- Denver Rock Island Railroad Consolidation & Relocation

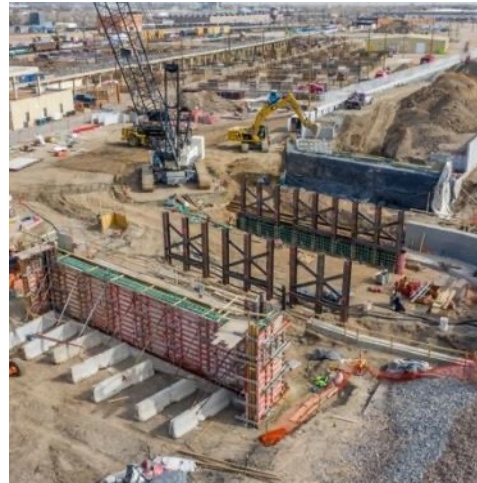
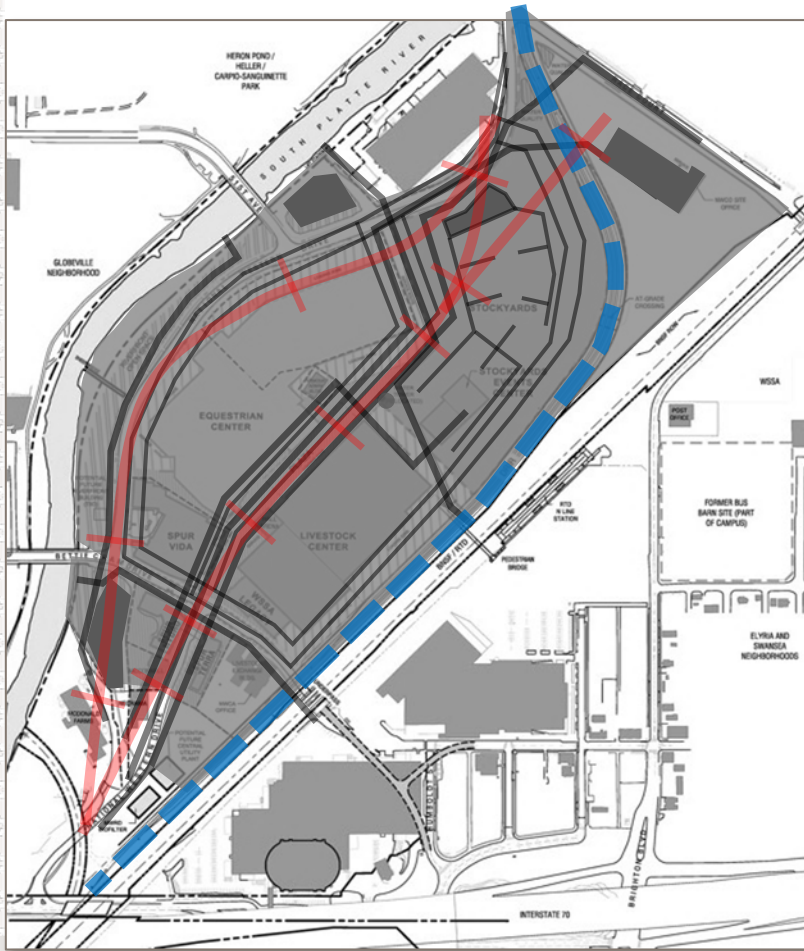

PHASE 1 & 2 PROGRAM STATUS

WORK COMPLETED

- Stockyards Event Center
- Multi-Use Stockyards



PHASE 1 & 2 PROGRAM STATUS

WORK COMPLETED

- Multimodal Facilities

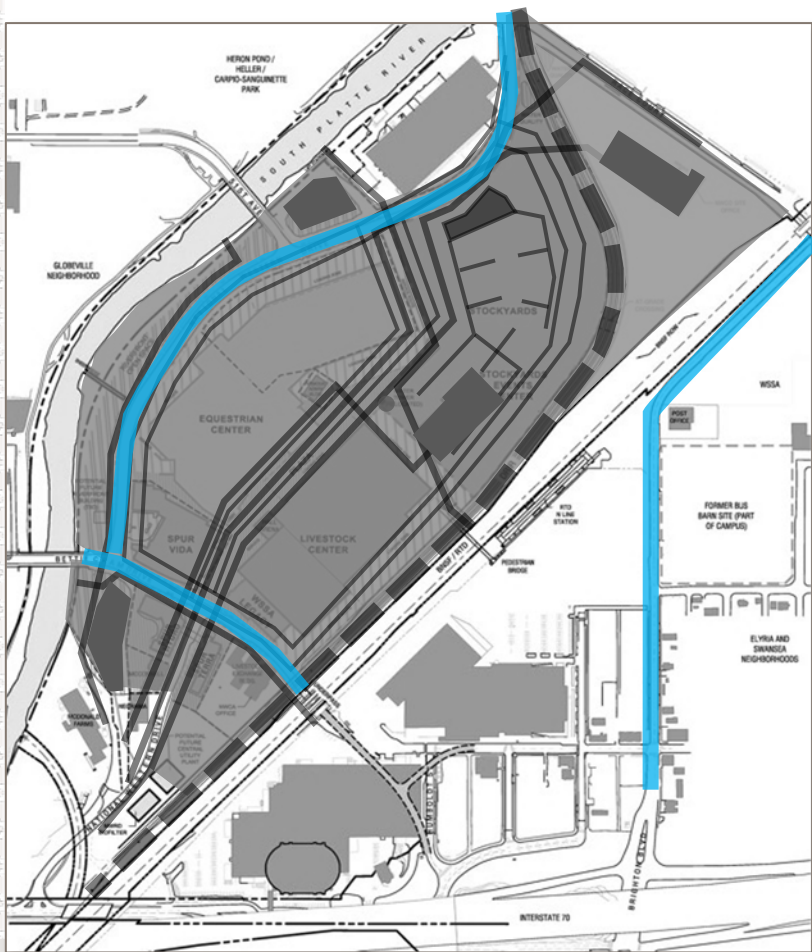

PHASE 1 & 2 PROGRAM STATUS

WORK COMPLETED

- Cumulative Work to Date

- Sitewide Land Preparation
- Sitewide Utilities
- Major Drainage and Water Quality Facilities
- Maintenance and Operations Building
- Denver Rock Island Railroad Relocation
- Stockyards Event Center
- Multi-Use Stockyards
- Multimodal Facilities

- Work Completed by Others:

- RTD North Metro Station
- CSU Spur Vida
- Central Utility Plant



PHASE 1 & 2 PROGRAM STATUS

WORK IN-PROGRESS

PHASE 1 & 2 PROGRAM STATUS

WORK IN-PROGRESS

- National Western Drive

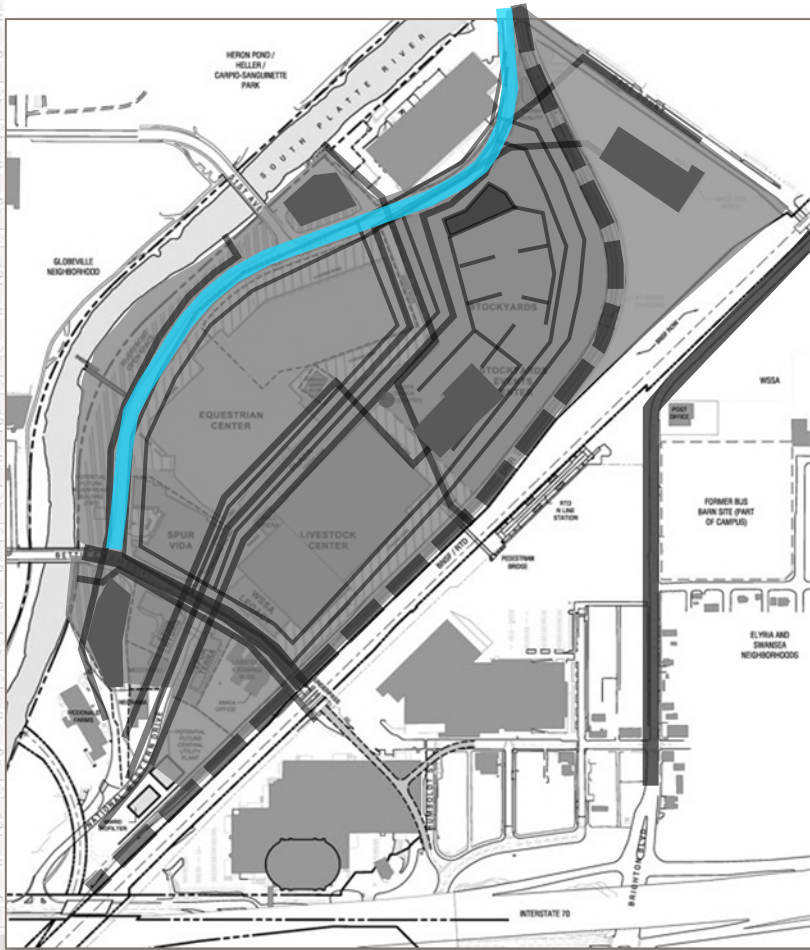

PHASE 1 & 2 PROGRAM STATUS

WORK IN-PROGRESS

- 51st Avenue Bridge

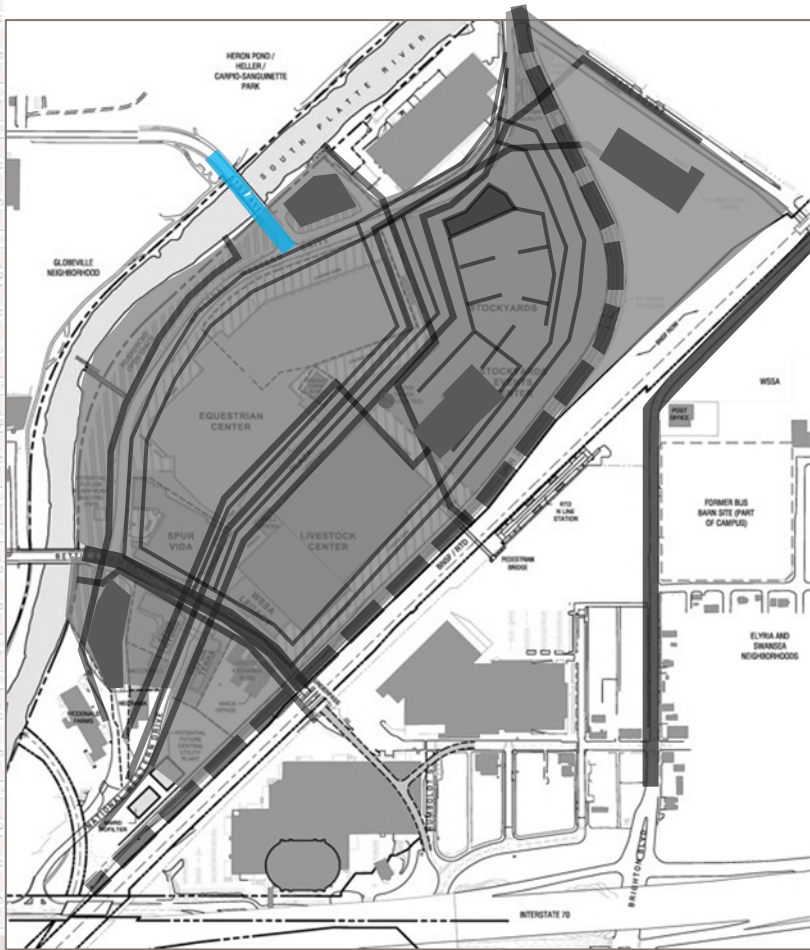

PHASE 1 & 2 PROGRAM STATUS

WORK IN-PROGRESS

- Riverfront Open Space

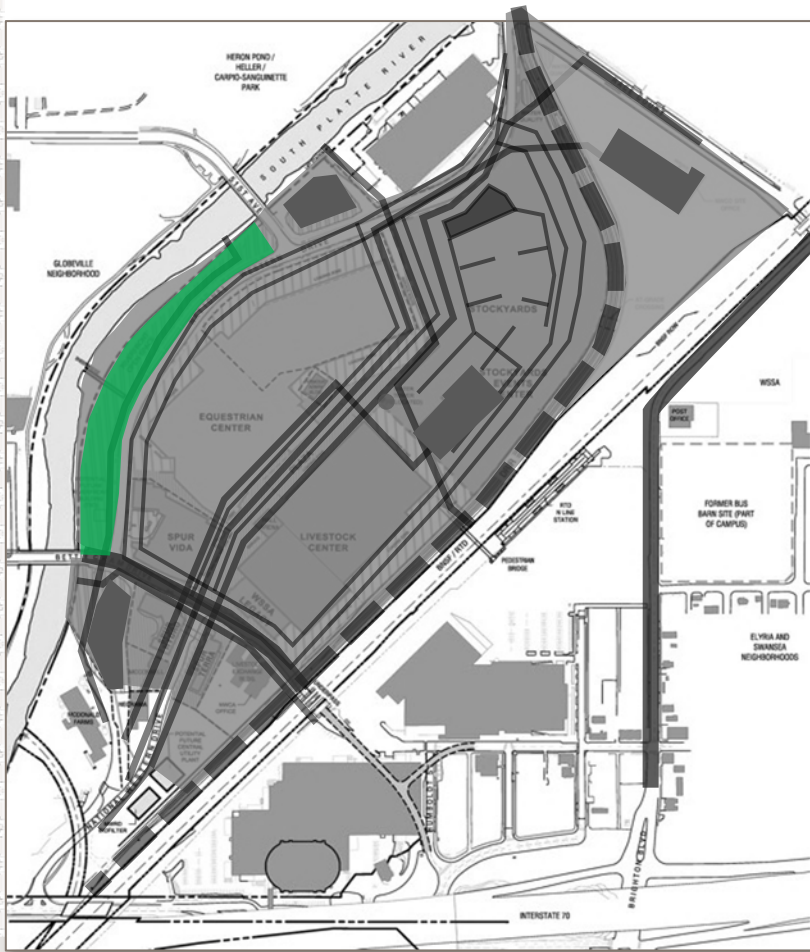

PHASES 1 & 2 PROGRAM STATUS REPORT



NATIONAL WESTERN CENTER - PHASES 1 & 2

Program Status Report

Q1-2022

HANDOUT

QUARTERLY STATUS	
Overview:	Horizontal:
- HSSE: 0 recordable incidents this quarter	- Design in-progress: campus IT, pedestrian bridge / mobility
- NWC Program schedule - SPI 1.00 *	- Procurement in-progress: campus IT
- NWC Program budget - CPI 1.00 *	- Construction in-progress: pad-ready sites for plaza, riverfront, and stockyards;
	NW Dr, Bettie Cram Dr, utilities, interim plaza / parking; 51st Ave River Bridge
	- Completed: site stabilization and interim plaza / parking
Program-Wide:	Vertical:
- Continued horizontal/vertical design, procurements	- SYEC: continued punchlist, FF&E and transition for year-round events
- Continued regulatory planning and permitting	- Stockyards: continued punchlist, FF&E and transition for year-round events
- Continued Public Art process	- Equestrian Center: in design development; construction start TBD *
- Completed campus / facilities ready for SS2022	- Livestock Center: in design development; construction start TBD *
* Continuing to assess potential COVID-19, market impacts, design options, costing, recovery opportunities on program / schedule	

Bettie Cram Drive Looking East

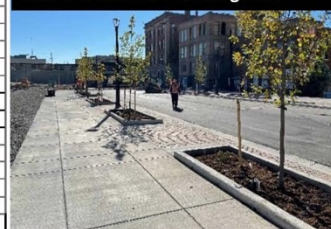

MAJOR CONTRACTS AND PROCUREMENT STATUS				
	Vendor	Description	Contracted Date	Amount
Contracted	Wilson & Co	Brighton Blvd - Design	Dec 2016	\$ 1,050,044
	Moore Iacofano Goltsman (MIG)	Campus Placemaking	Jun 2017	\$ 5,000,000
	Saunders Construction LLC	Demolition and Abatement	Sep 2017	\$ 18,000,000
	Kiewit Infrastructure Co	Brighton Blvd - Construction	Dec 2017	\$ 12,604,322
	Merrick & Company	Horizontal Design	Apr 2018	\$ 25,000,000
	Wilson & Co	DRIR Rail Consolidation	Apr 2018	\$ 2,190,687
	Hensel Phelps Construction	Horizontal Integrated Construction (HIC)	Jun 2018	\$ 275,000,000
	Short, Elliot and Hendrickson (S.E.H.)	Maint. & Ops Facility - Design	Sep 2018	\$ 776,758
	HKS, Inc.	Stockyards Event Cntr / Stockyards - Design	Nov 2018	\$ 3,659,443
	G.H. Phipps	Maint. & Ops Facility - Precon	Dec 2018	\$ 15,000
	Adolfson & Peterson	Stockyard Event Cntr / Stockyards - Precon	Mar 2019	\$ 37,500
	Populous	Equestrian Center / Parking Garage - Design	May 2019	\$ 10,831,281
	G.H. Phipps	Maint. & Ops Facility - CM/GC	Dec 2019	\$ 5,335,422
	Adolfson & Peterson	Stockyard Event Cntr / Stockyards - CM/GC	Dec 2019	\$ 8,529,490
	Whiting - Turner	Equestrian Center / Parking Garage - Precon	Dec 2019	\$ 2,443,650
Projected	Populous	Livestock Center - Design	Feb 2020	\$ 10,557,527
	Whiting - Turner	Livestock Center - Precon	Oct 2020	\$ 2,016,700
	Whiting - Turner	Livestock Center - CM/GC	TBD **	TBD
	Whiting - Turner	Equestrian Center / Parking Garage - CM/GC	TBD **	TBD
* Capacity ** Continuing to assess potential COVID-19, market impacts, design options, costing, recovery opportunities on program/schedule				

* Capacity ** Continuing to assess potential COVID-19, market impacts, design options, costing, recovery opportunities on program/schedule

KEY PERFORMANCE INDICATORS	
Description	
Health , Safety, Security, and Environment	
Cost	
Schedule	
Design	
Community	
ReNEWW	
Concurrent Operations	





NEXT STEPS AND COUNCIL ACTIONS

Next 3 Months

- Detailed Design + Estimating + Construction Phasing
 - Livestock Center, Equestrian Center, Bettie Cram, and Pedestrian Bridge

Next 6 Months

- Assess Market Conditions
- Contracts – Design, Management, and Construction
- Regulatory / Agreements - Plat, WSSA Legacy Building Construction

Ongoing Coordination

- Campus Wide
- CSU Hydro and Terra Building Construction
- WSSA Legacy Building Construction
- WSSA, Authority, and CSU Programming / Concurrent Operations
- Future Phases



NATIONAL WESTERN CENTER AUTHORITY





VISION

To be the global destination for agricultural heritage and innovation.

MISSION

Convene the world at the National Western Center to lead, inspire, create, educate and entertain in pursuit of global food solutions.

STOCKYARDS EVENT CENTER



PROCUREMENTS UPDATE

VENDOR OPEN HOUSE 4/4/22



National Western Center Vendor Open House

April
4th

Join the National Western Center Authority for an outreach event to connect with local certified and non-certified businesses about upcoming procurement opportunities at the new National Western Center. Opportunities include:

- Janitorial services, supplies
- Landscaping
- Snow removal
- Event staffing
- Catering and concessions
- Various on-call facility trades

WHEN:

Monday, April 4, 2022, 4 p.m. - 6 p.m.

WHERE:

Stockyards Event Center (see map attached)
5004 National Western Drive, Denver, CO 80216

Pre-registration required
[CLICK HERE](#)





JURASSIC WORLD: THE EXHIBITION



SUMMARY OF NEAR-TERM SERVICES AND SUPPLIES NEEDS

	Service	Facilities	Anticipated RFP Release Timing	Date Needed
1	Janitorial services and supplies	SYEC, Yards, ROW, Riverfront	May 2022	Sept 2022
2	Landscaping and snow removal	SYEC plazas, M&O, Yards, ROW, Riverfront	May 2022	Sept 2022
3	Event staffing FOH and BOH	SYEC, Yards, Riverfront	June 2022	Oct 2022
4	Catering preferred vendors	SYEC, Yards, Riverfront	June 2022	Oct 2022
5	Facilities PM and on-call services	SYEC, Yards, M&O	Ongoing	Ongoing

COMMUNITY PARTNERSHIPS

- Technical Assistance Grant - \$400,000
 - Fiscal agent procurement
 - Transfer of funds to Community Investment Fund
- Community Process
 - Regularly scheduled meetings (facilitator selection process)
 - Engagement efforts: doorhanger program, text message platform, signage
 - Continue to provide translation./ interpretation on all mediums
- Open position: Dir. of Community Engagement & Government Affairs
 - Leading community discussions, negotiations, and outreach
 - Managing Denver City Council communications





DISTRICT ENERGY SYSTEM

Central Utility Plant



NATIONAL WESTERN CENTER



-
-  nationalwesterncenter.com
 -  facebook.com/nationalwesterncenter
 -  twitter.com/DiscoverTheWest
 -  instagram.com/national.western.center
 -  linkedin.com/company/national-western-center/